



REPLACE



CCT Selectable + Dimming Switch

Specifications

| Model No. | Power | LED | PF | CRI | Voltage | CCT | Lumen | Size mm (x0.0393=inch) | Operation temp (°C / °F) | Weight kg (lbs=kgx2.2) | Certificate | Equal to |
|--------------|-------|------|------|-----|-----------------------|-------------------------|--|---------------------------------|-----------------------------|---------------------------|-------------------|----------------|
| GKS38-20W-11 | 20W±2 | 2835 | ≥0.9 | ≥80 | 100-277VAC 50-60Hz | 3000K 4000K 5000K | 3000lm±10% 1500lm±10% 850lm±10% | E26:138*92*72 EX39:154*92*72 | -30~45°C -22~-113°F | NW:0.46 GW:0.58 | CE ROHS DLC UL | 100WHPS MHL |
| | 10W±2 | | | | | | | | | | | |
| | 5W±2 | | | | | | | | | | | |
| GKS38-30W-11 | 30W±3 | 2835 | ≥0.9 | ≥80 | 100-277VAC 50-60Hz | 3000K 4000K 5000K | 4500lm±10% 3200lm±10% 1700lm±10% | E26:178*92*72 EX39:194*92*72 | -30~45°C -22~-113°F | NW:0.67 GW:0.81 | CE ROHS DLC UL | 125WHPS MHL |
| | 20W±2 | | | | | | | | | | | |
| | 10W±2 | | | | | | | | | | | |
| GKS38-40W-11 | 40W±4 | 2835 | ≥0.9 | ≥80 | 100-277VAC 50-60Hz | 3000K 4000K 5000K | 6000lm±10% 4700lm±10% 3200lm±10% | E26:198*92*72 EX39:214*92*72 | -30~45°C -22~-113°F | NW:0.76 GW:0.90 | CE ROHS DLC UL | 200WHPS MHL |
| | 30W±3 | | | | | | | | | | | |
| | 20W±2 | | | | | | | | | | | |
| GKS38-60W-11 | 60W±6 | 2835 | ≥0.9 | ≥80 | 100-277VAC 50-60Hz | 3000K 4000K 5000K | 9000lm±10% 6500lm±10% 3200lm±10% | E26:269*92*72 EX39:253*92*72 | -30~45°C -22~-113°F | NW:1.02 GW:1.18 | CE ROHS DLC UL | 250WHPS MHL |
| | 40W±4 | | | | | | | | | | | |
| | 20W±2 | | | | | | | | | | | |

Features

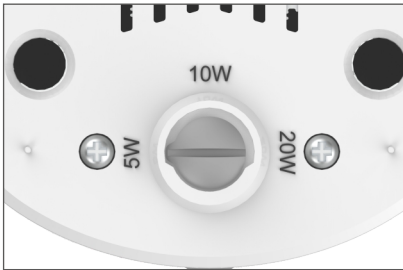

Dimming Switch

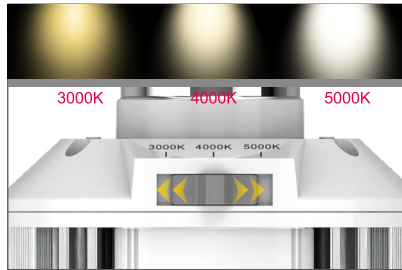

CCT selectable: 3000K 4000K 5000K



LED Chip : 2835

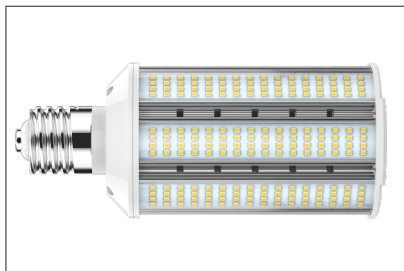

150Lm/W \pm 10%

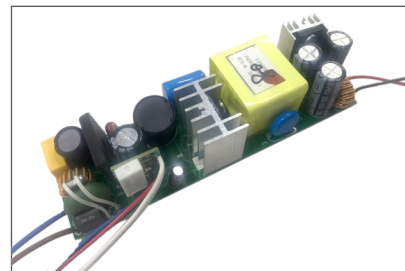

High quality

Application



Installation

Lamp Installation

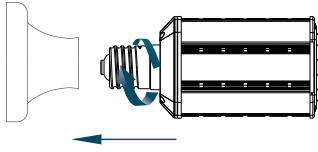

1. Turn off the power before installation.
Remove the old ballast, capacitor and ignitor (if any)

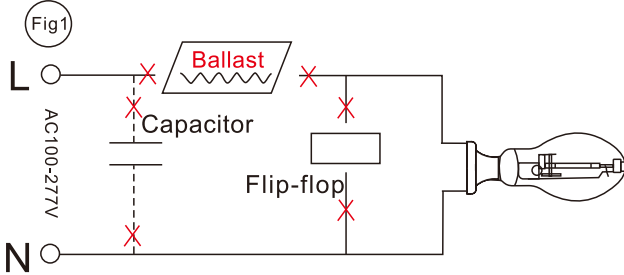

2. 1. Make sure the Alternating Current wire is connected directly to the E39 socket (reconnect or replace the ground wire if necessary)

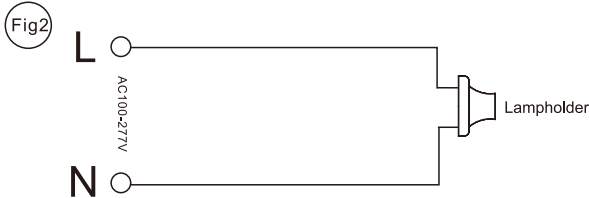

3. Screw the LED lamp to the corresponding socket.

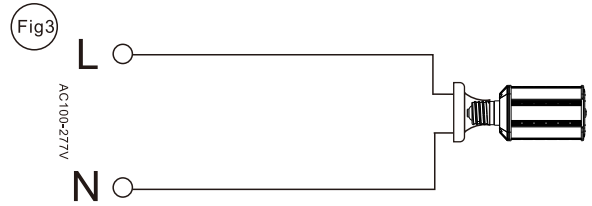

Securely fasten the ground lead cable to the main structure. If the cable is damaged in any way, please replace it (do not use a burned cable). If it needs to be replaced, the cable must be 1 mm in size and insulated.

Installation of mounting support

For install in a downward horizontal fixture and please cut it to the desired length with cutting pliers after installation. See chart A

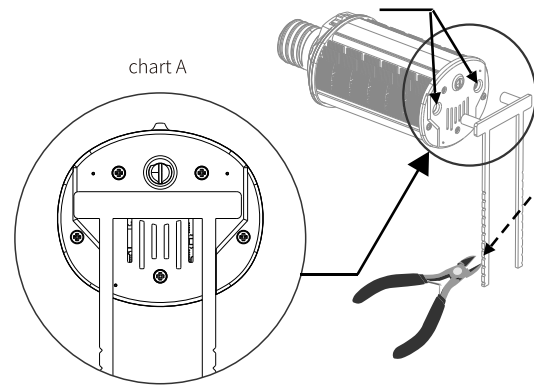

Packing

| watts | Inner box size(mm) (x0.0393=inch) | N.W per lamp(kg) (lbs=kgx2.2) | G.W per box(kg) (lbs=kgx2.2) | G.W per Carton(kg) (lbs=kgx2.2) | Carton size(mm) (x0.0393=inch) | Quantity per carton |
|-------|--------------------------------------|----------------------------------|---------------------------------|------------------------------------|-----------------------------------|---------------------|
| 20W | 93*93*190mm | 0.46kg | 0.58kg | 14.69kg | 390*296*396mm | 24pcs |
| 30W | 102*102*238mm | 0.67kg | 0.81kg | 10.53kg | 425*322*253mm | 12pcs |
| 40W | 102*102*258mm | 0.76kg | 0.96kg | 12.19kg | 425*322*273mm | 12pcs |
| 60W | 102*102*305mm | 1.02kg | 1.18kg | 14.85kg | 425*322*320mm | 12pcs |

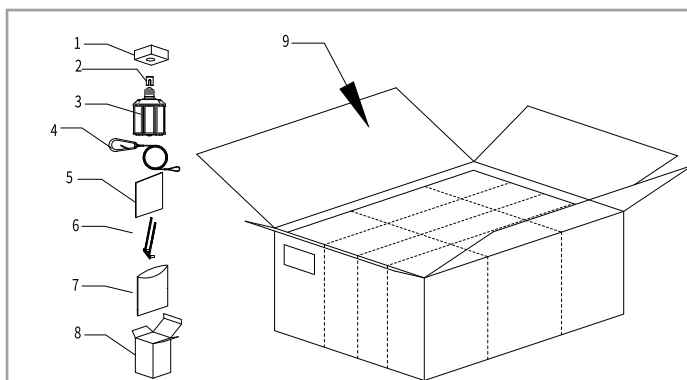

Packing list

Note of mounting support: it's no need for 20W so not contained in its package. Other wattages are equipped with one.

| No. | Name | Qty. | Configuration |
|-----|-------------------|------|---------------|
| 1 | Cardboard | 1 | Standard |
| 2 | Lamp base cover | 1 | Standard |
| 3 | Lamp | 1 | Standard |
| 4 | Safety rope | 1 | Optional |
| 5 | Neutral manual | 1 | Standard |
| 6 | Mounting support | 1 | Standard |
| 7 | Neutral PE bag | 1 | Standard |
| 8 | Neutral color box | 1 | Standard |
| 9 | Neutral carton | 1 | Standard |

CAUTIONS

- Risk of electric shock. Do not use in places where directly exposed to water.
- 20W 30W 40W 60W are suitable for using in totally enclosed fixtures.
- Don't take apart the lamps without our permit.
- Please read the manual carefully before installation.

