

Underlayment Detail

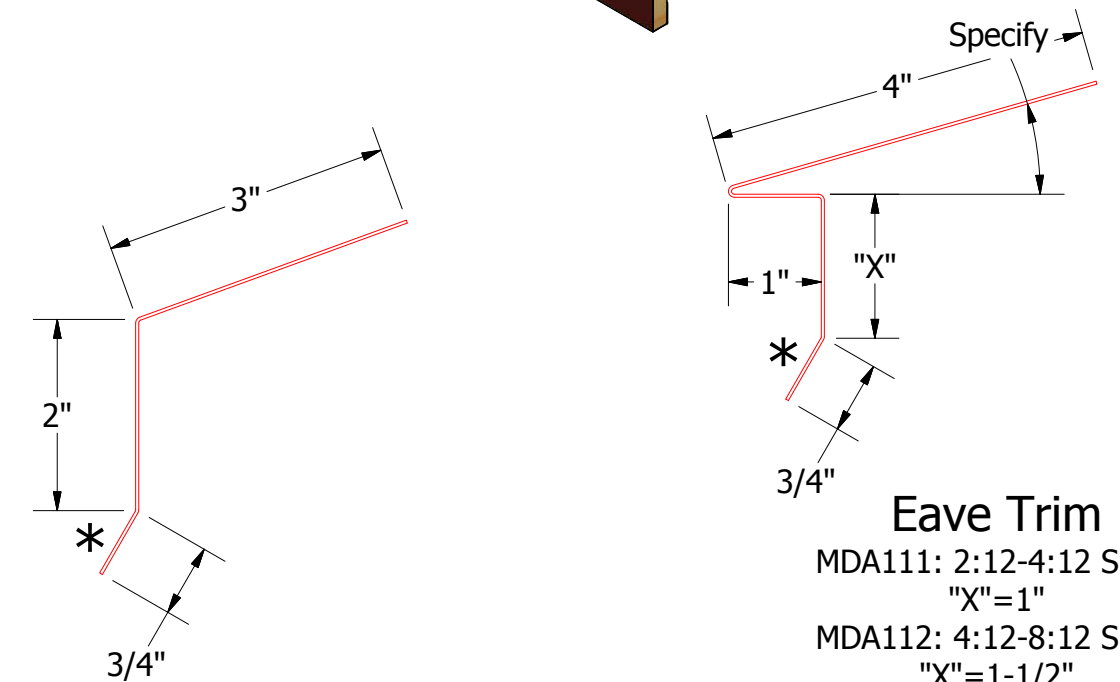
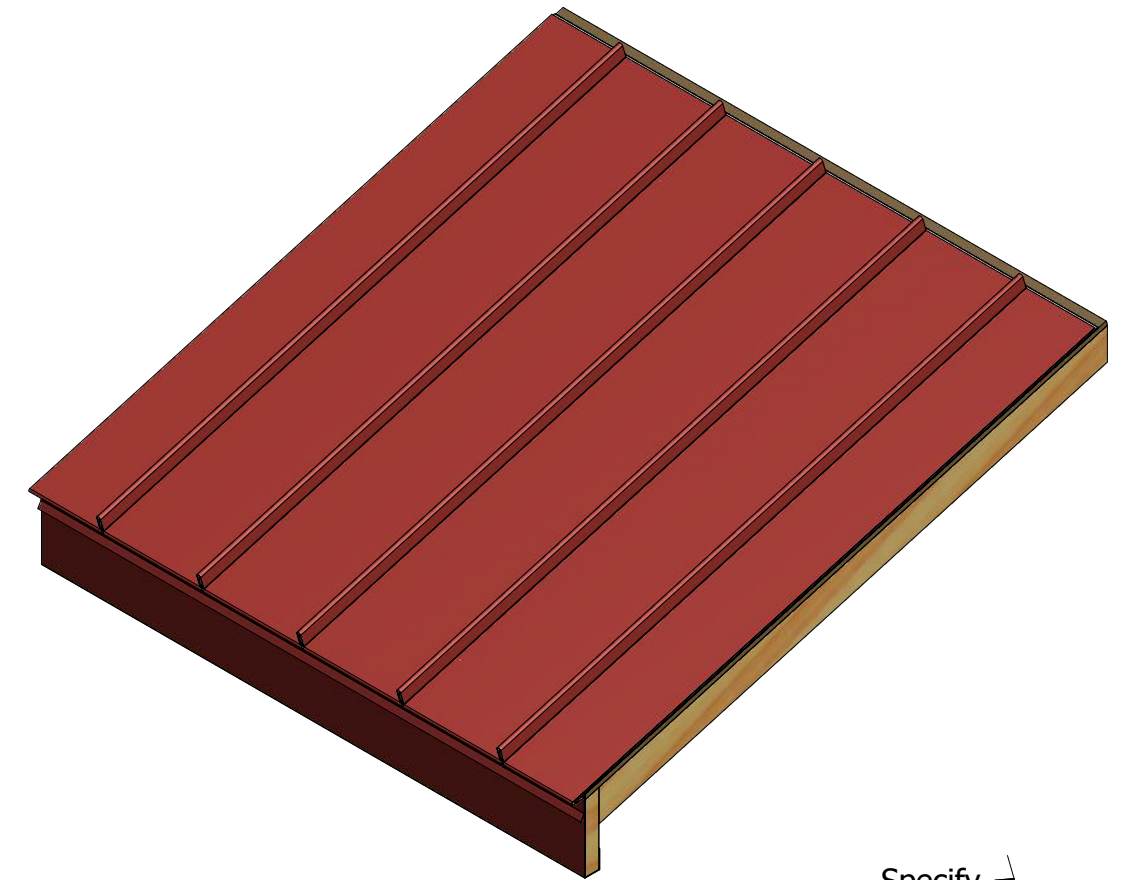
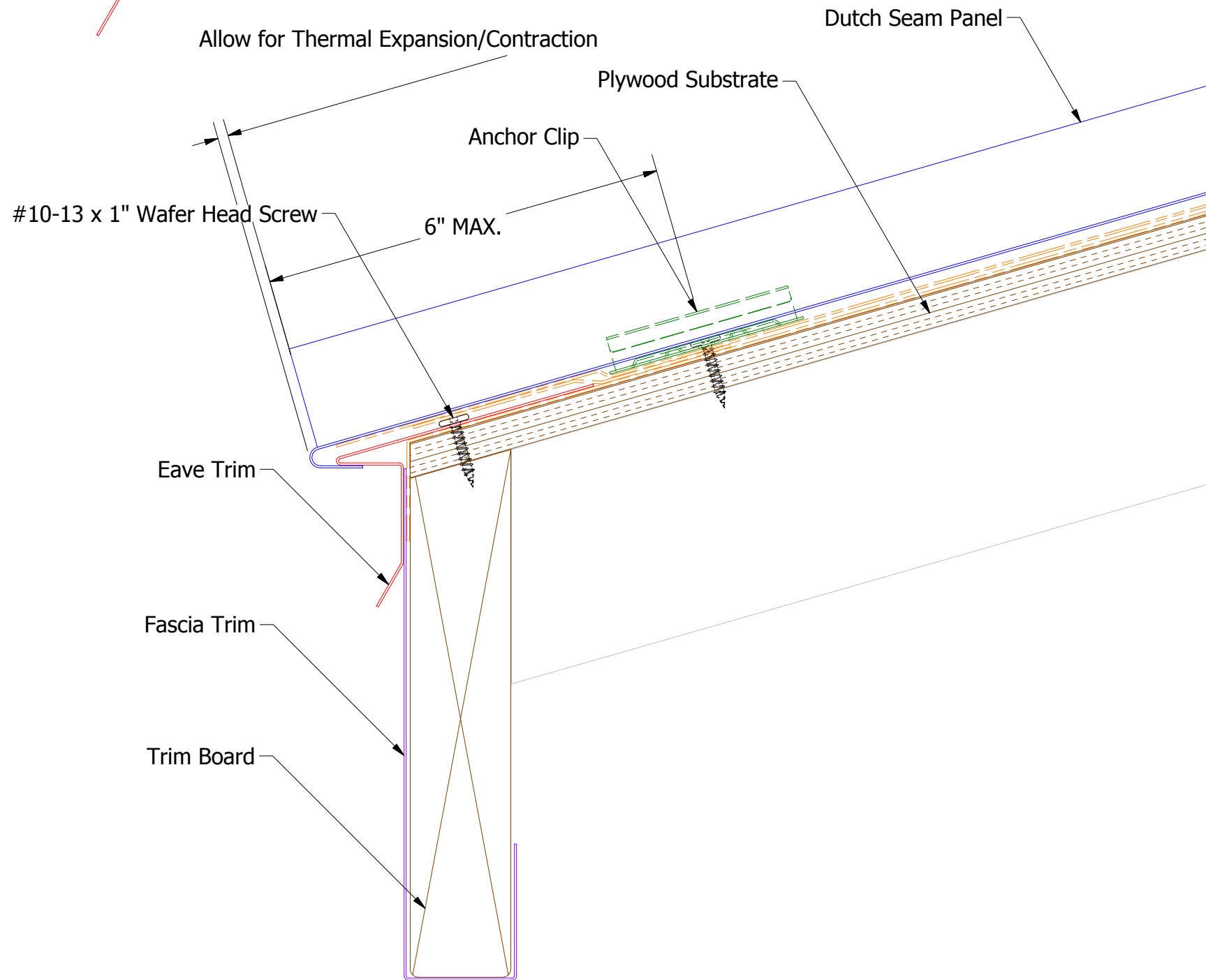

Eave Trim

- MDA111: 2:12-4:12 Slope
"X"=1"
- MDA112: 4:12-8:12 Slope
"X"=1-1/2"
- MDA113: 8:12-12:12 Slope
"X"=2"

MDA115-Eave Trim without Return

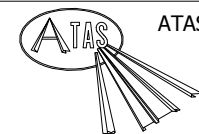

ATAS INTERNATIONAL, INC
Allentown PA
610-395-8445
Mesa AZ
480-558-7210

TITLE					MRD Eave Detail				
REV. NO.		DATE		DESCRIPTION OF REVISION		BY		APP	
DWG. NO.		DR		KRK		DATE		1/15/2014	
MATERIAL		SH. SIZE		B		SCALE		X:X	

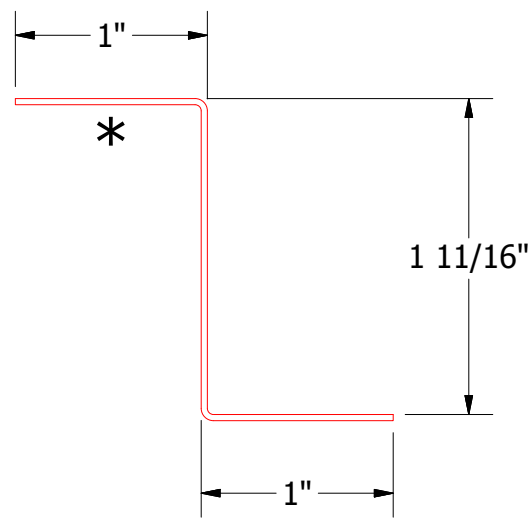

MDA910-Z Closure

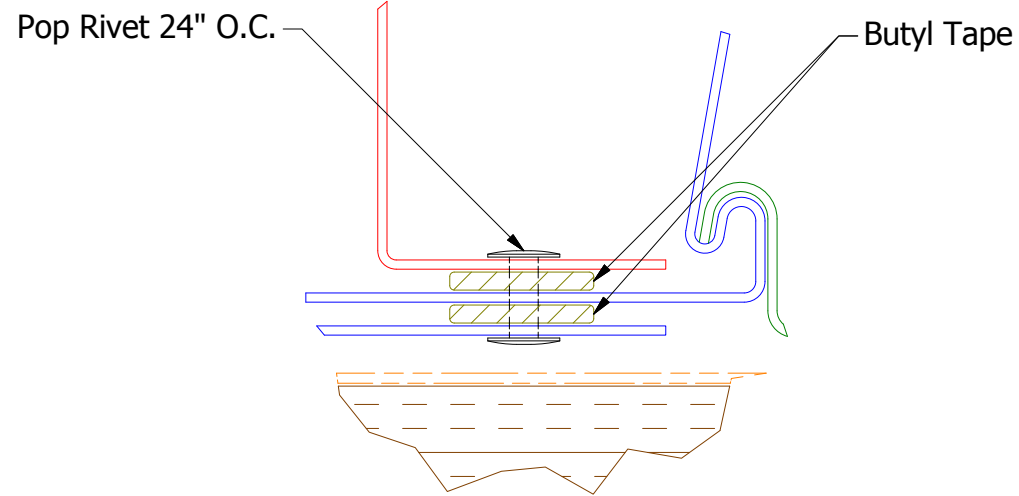

DETAIL A

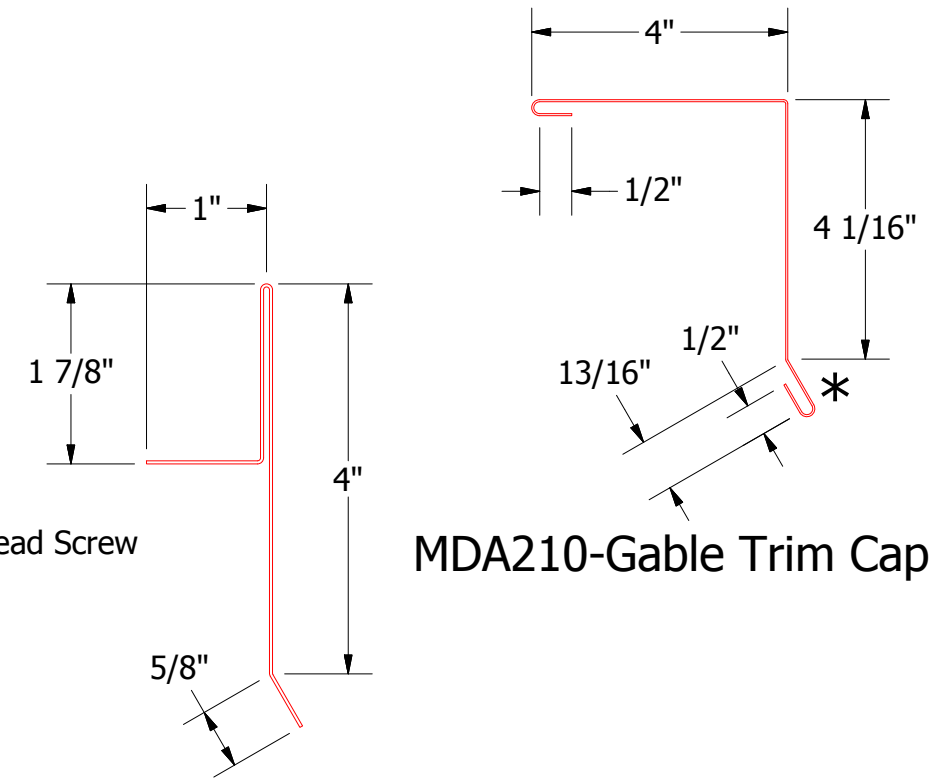
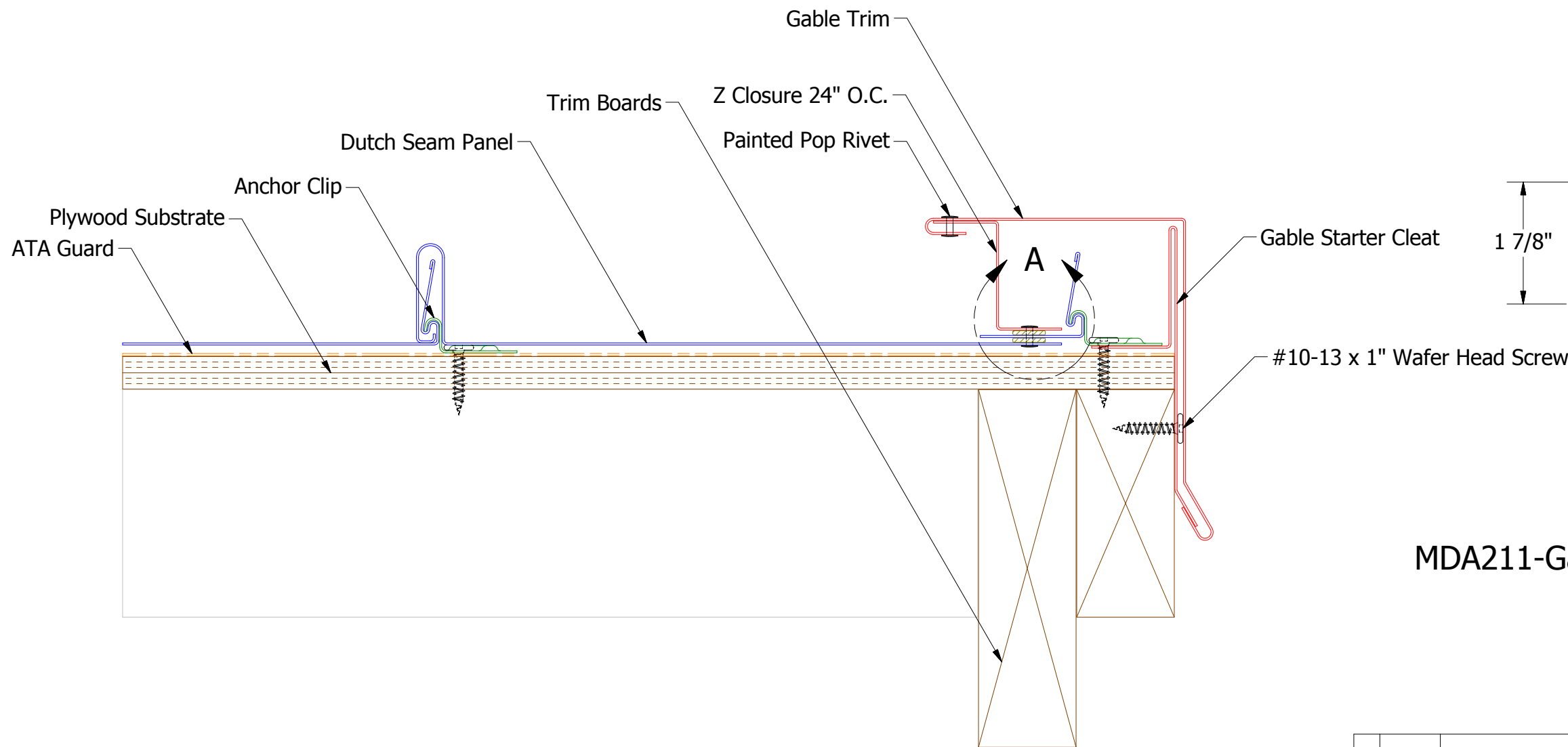
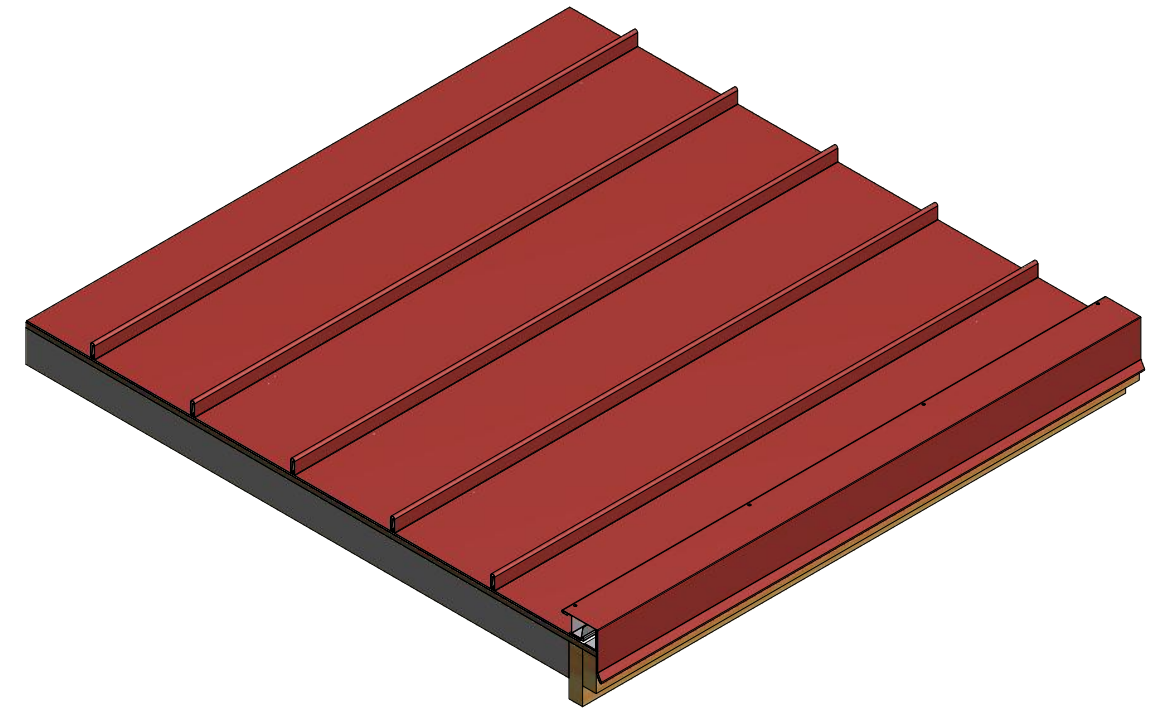

MDA210-Gable Trim Cap

MDA211-Gable Trim Starter Cleat

ATAS
 ATAS INTERNATIONAL, INC
 Allentown PA
 610-395-8445
 Mesa AZ
 480-558-7210

TITLE		MRD Ending Gable Detail	
DWG. NO.	DR	APP	DATE
	KRK		1-15-2014
MATERIAL	SH. SIZE	SCALE	
	B	X:X	

REV. NO.	DATE	DESCRIPTION OF REVISION	BY	APP

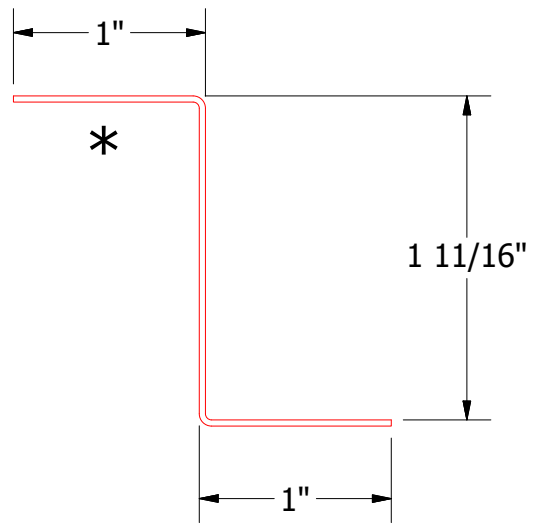

MDA910-Z Closure

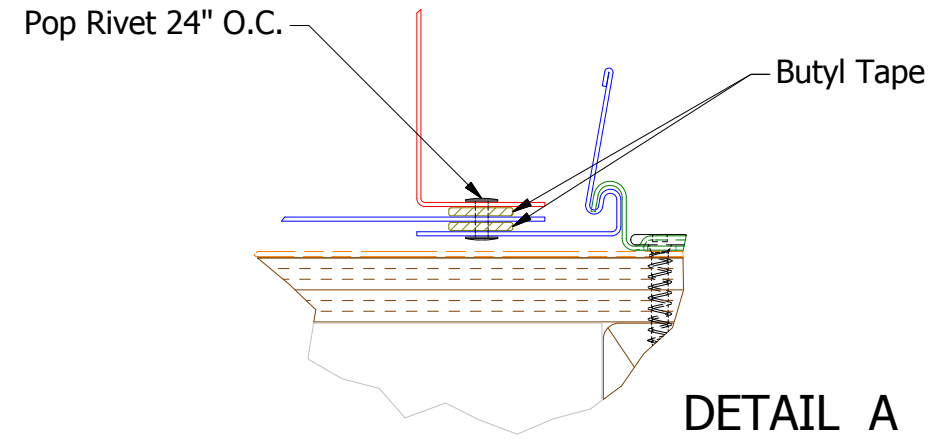

DETAIL A

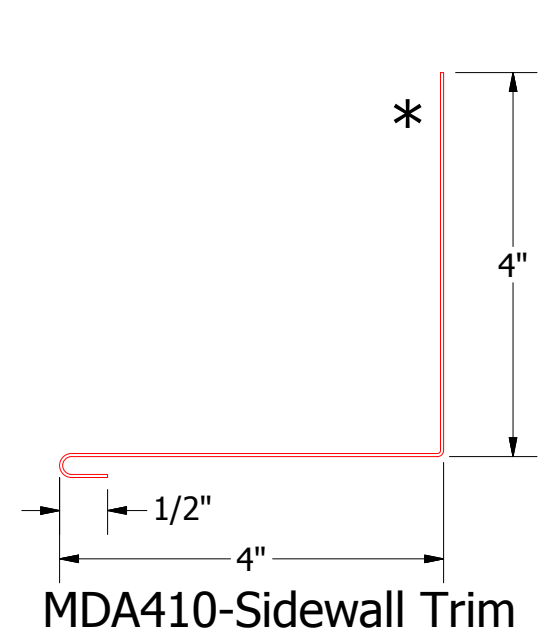
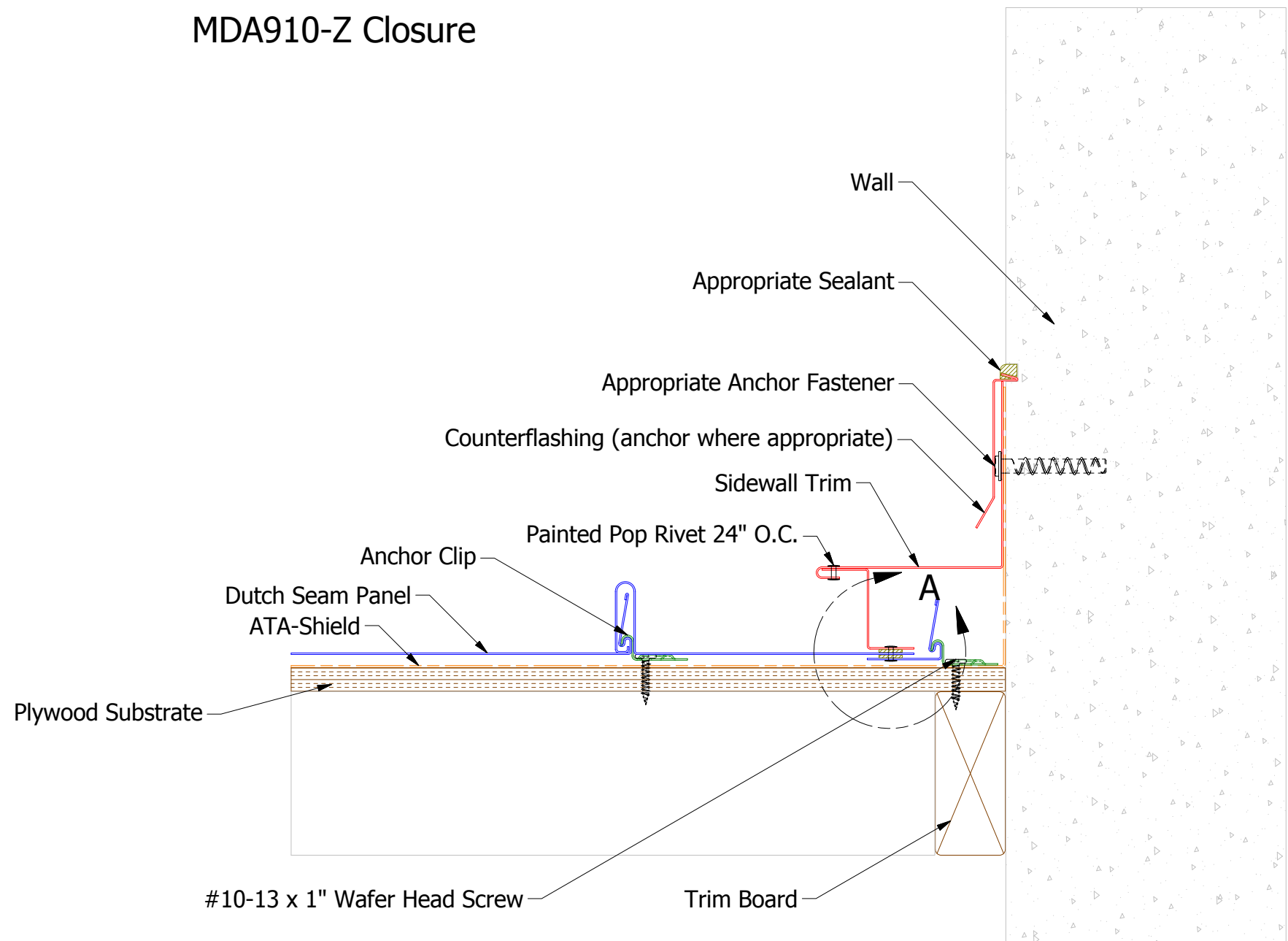
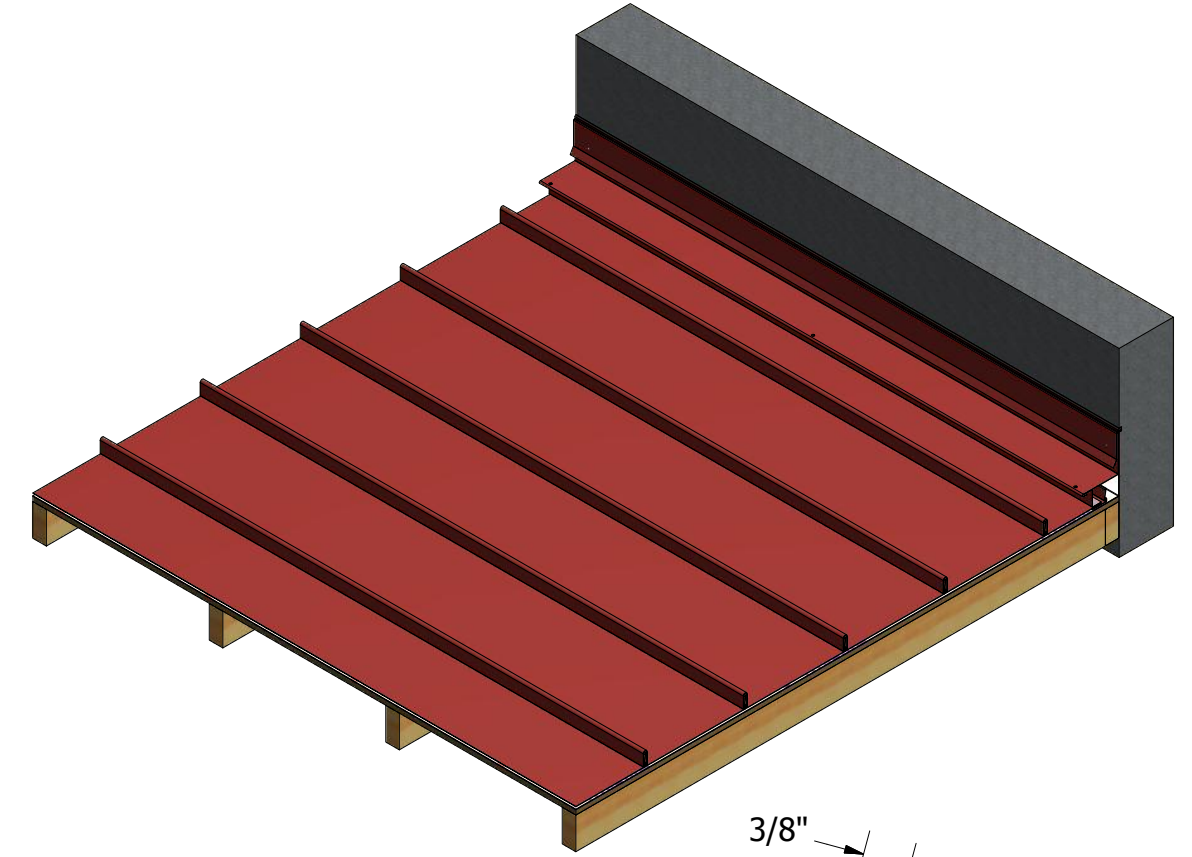

MDA410-Sidewall Trim

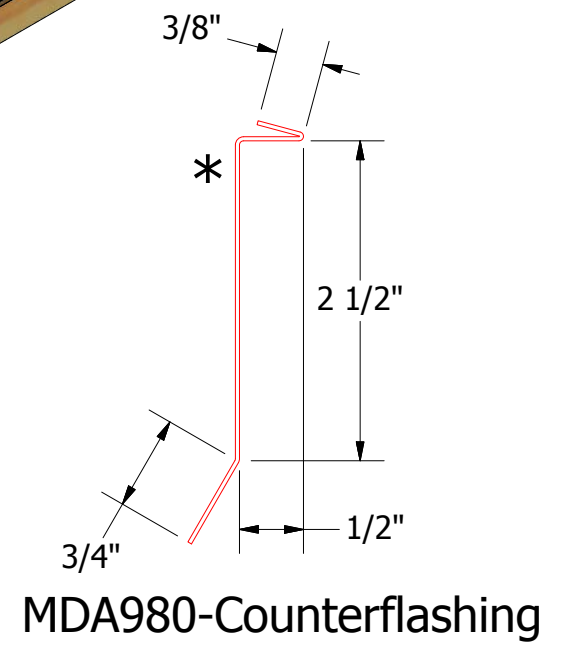

MDA980-Counterflashing

ATAS INTERNATIONAL, INC
 Allentown PA
 610-395-8445
 Mesa AZ
 480-558-7210

TITLE				MRD Ending Rake Sidewall Detail			
DWG. NO.		DR		DATE		DATE	
		KRK		1-17-2014			
MATERIAL		APP		DATE			
REV. NO.		DATE		DESCRIPTION OF REVISION		BY APP	
						SH. SIZE B SCALE X:X	

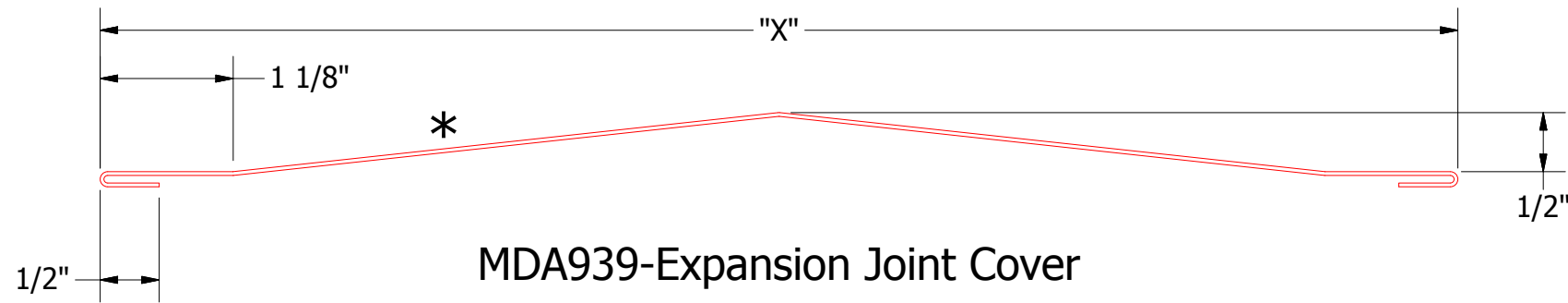

MDA939-Expansion Joint Cover

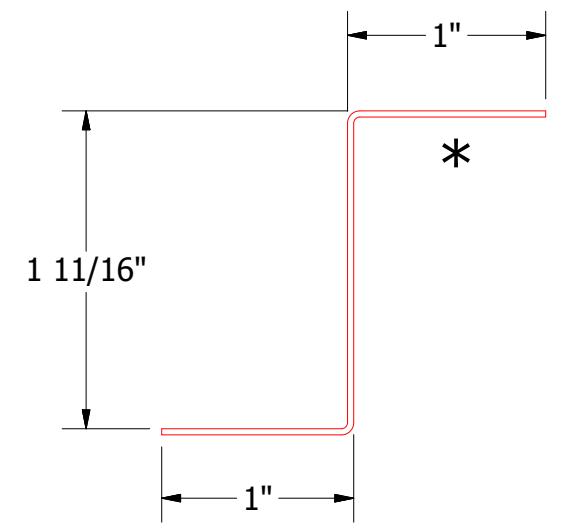
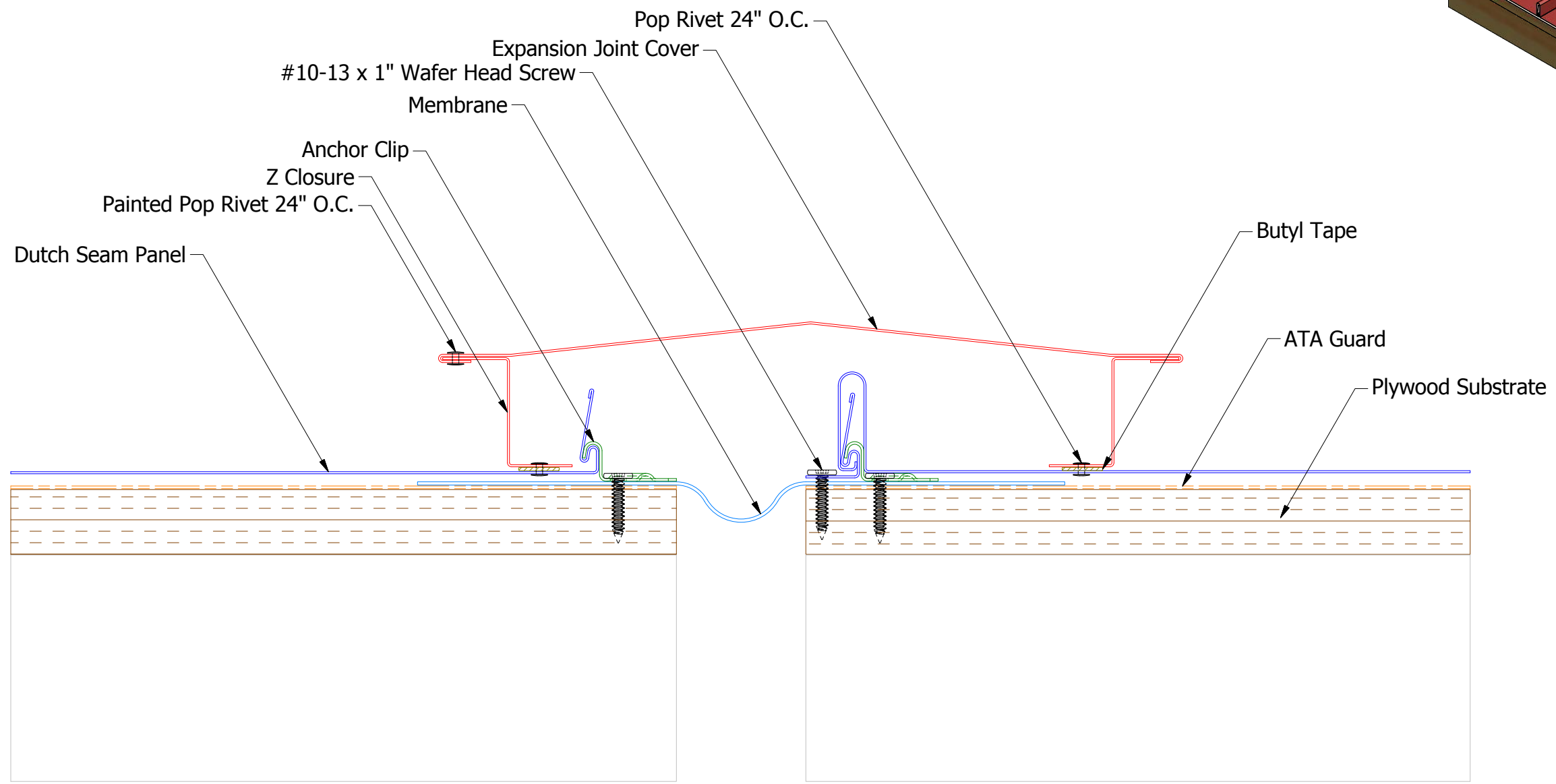
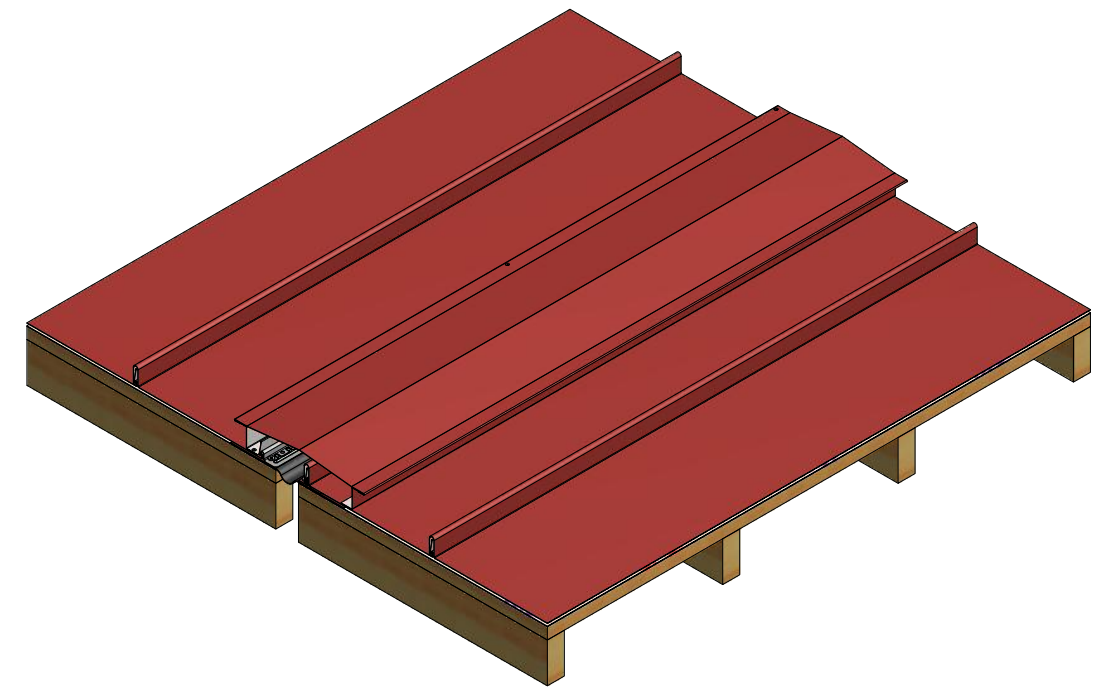

MDA910-Z Closure

Note: One end left unfastened to allow for expansion.

ATAS INTERNATIONAL, INC
 Allentown PA
 610-395-8445
 Mesa AZ
 480-558-7210

TITLE				MRD Expansion Joint Detail	
DWG. NO.		DR		DATE	
		KRK		7/11/2014	
MATERIAL		APP		DATE	
REV. NO.	DATE	DESCRIPTION OF REVISION	BY	APP	SCALE
					X:X

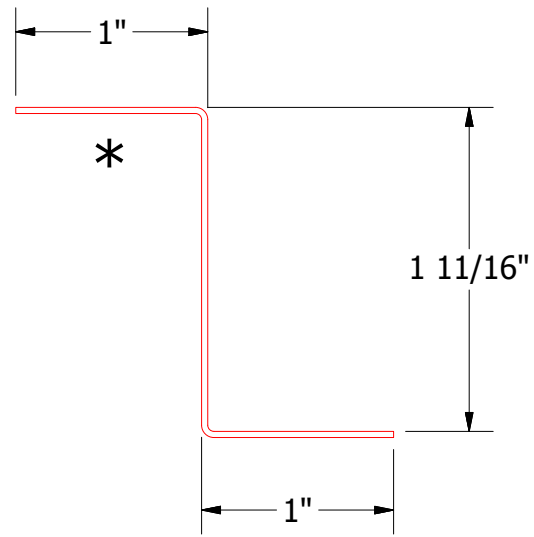

MDA910-Z Closure

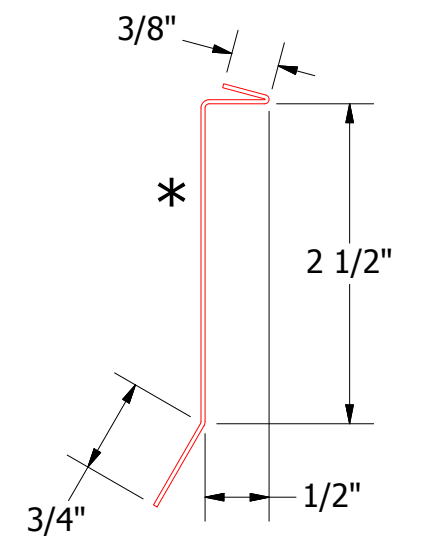
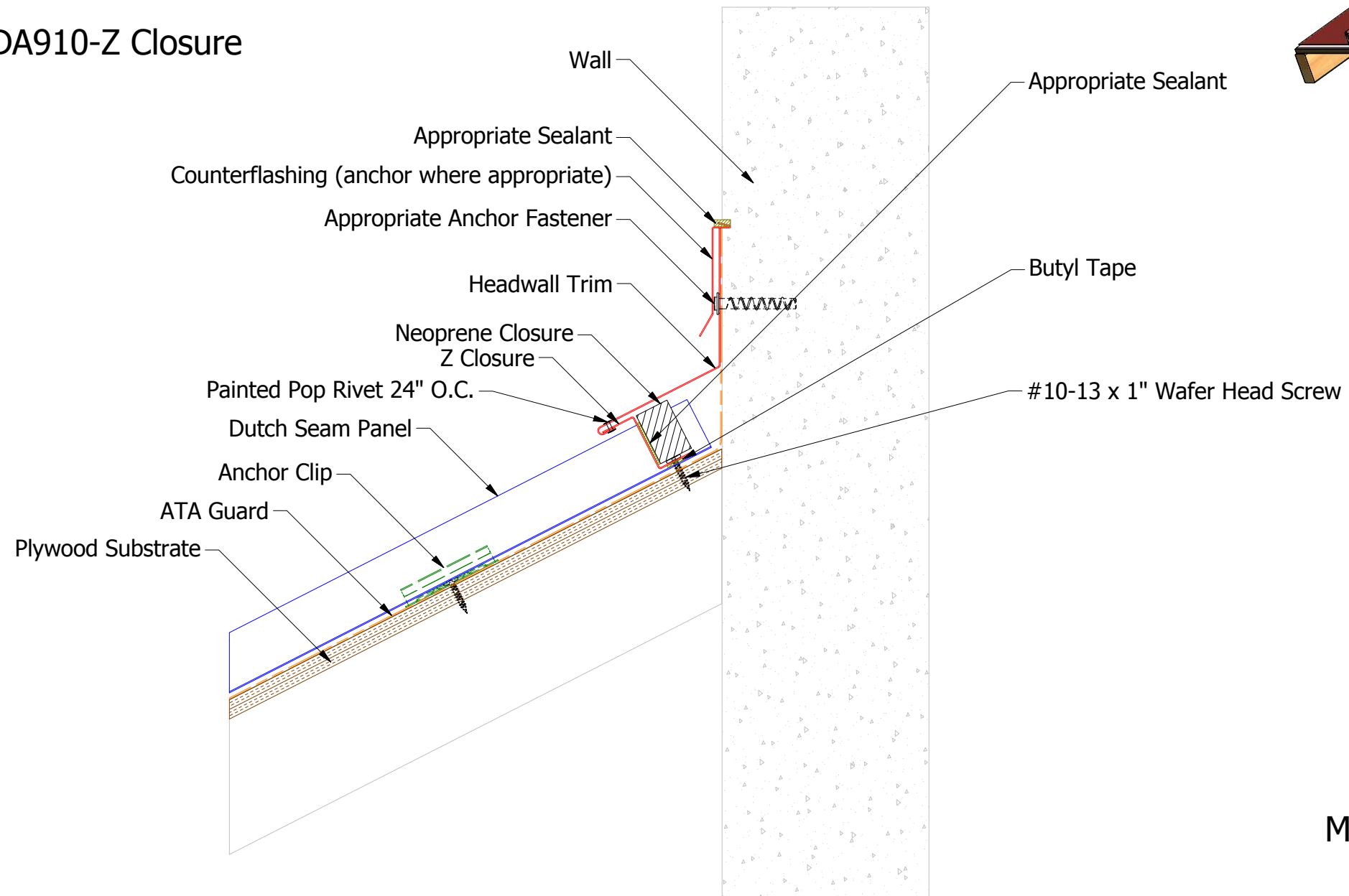
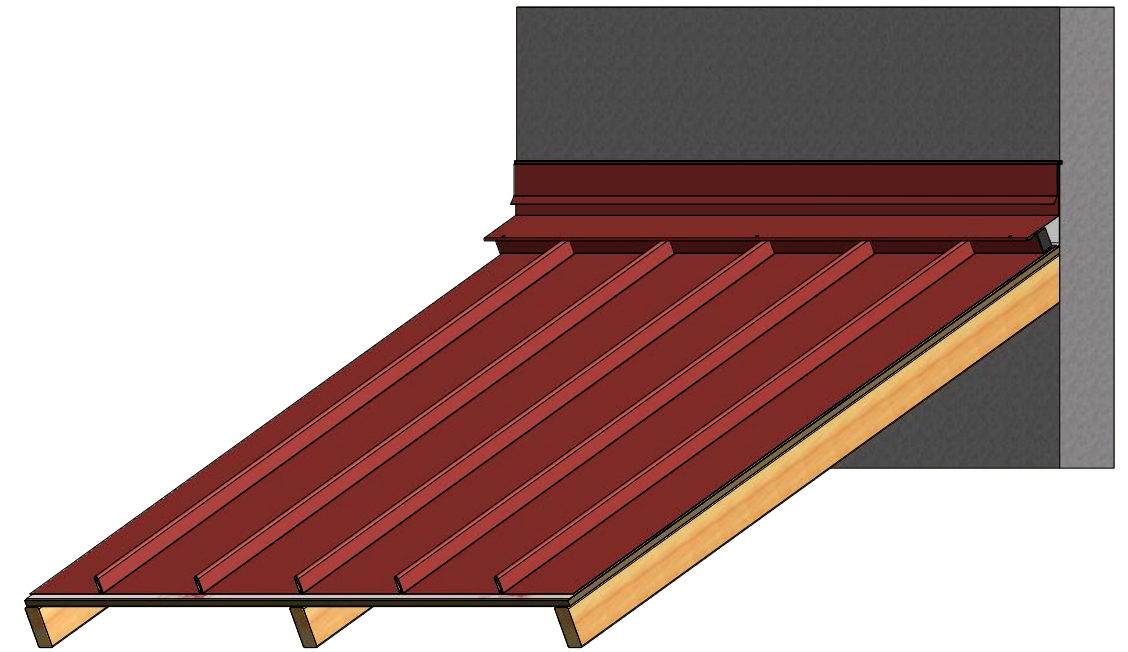

MDA980-Counterflashing

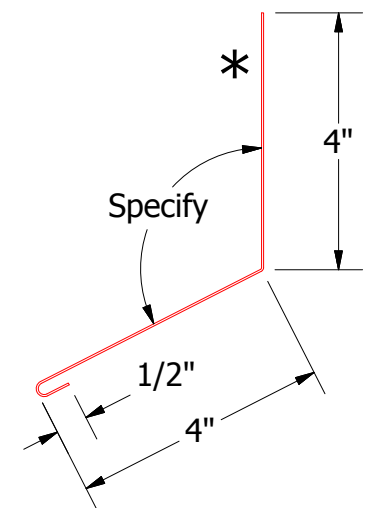

MDA500-Headwall Trim

Note: Neoprene Closures are not required if Factory Pre Notched Z Closures are utilized.

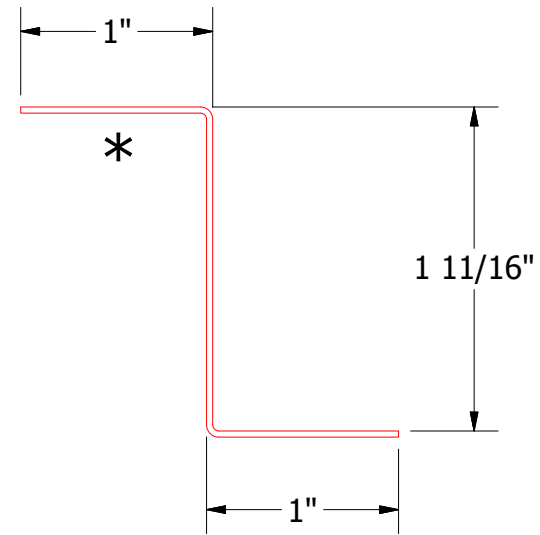

ATAS INTERNATIONAL, INC
 Allentown PA
 610-395-8445
 Mesa AZ
 480-558-7210

TITLE				MRD Headwall Detail	
DWG. NO.		DR		DATE	
		KRK		1-20-2014	
MATERIAL		APP		DATE	
REV. NO.	DATE	DESCRIPTION OF REVISION	BY	APP	SCALE
					B X:X

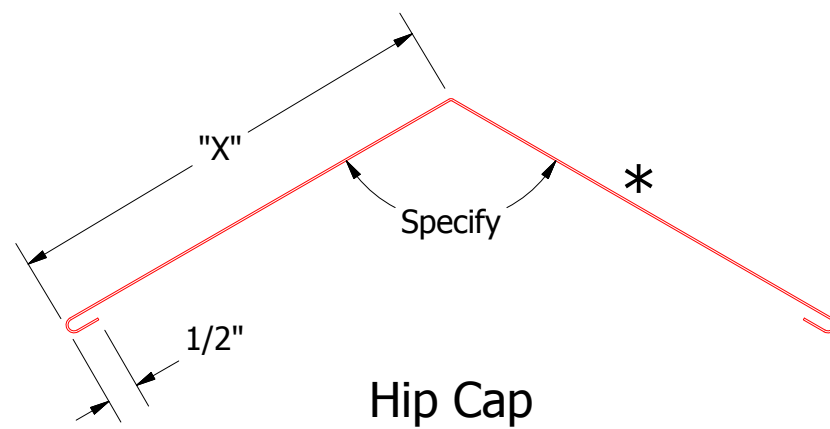

Pre Notched Z Closure

MDA931: For use with MRD110 Panel
 MDA932: For use with MRD150 Panel
 MDA933: For use with MRD194 Panel



Hip Cap

MDA315: 2:12-6:12 Slope
 "X" = 6"
 MDA316: 6:12-9:12 Slope
 "X" = 7"
 MDA317: 9:12-12:12 Slope
 "X" = 8"

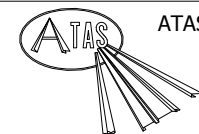
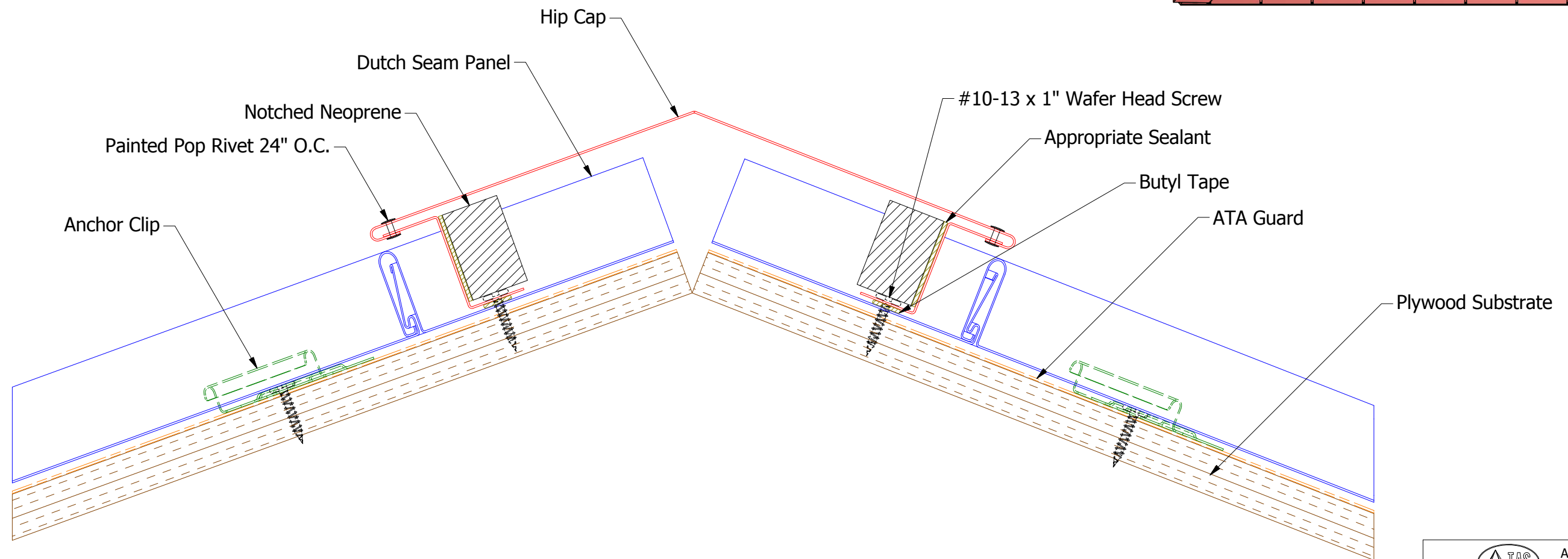
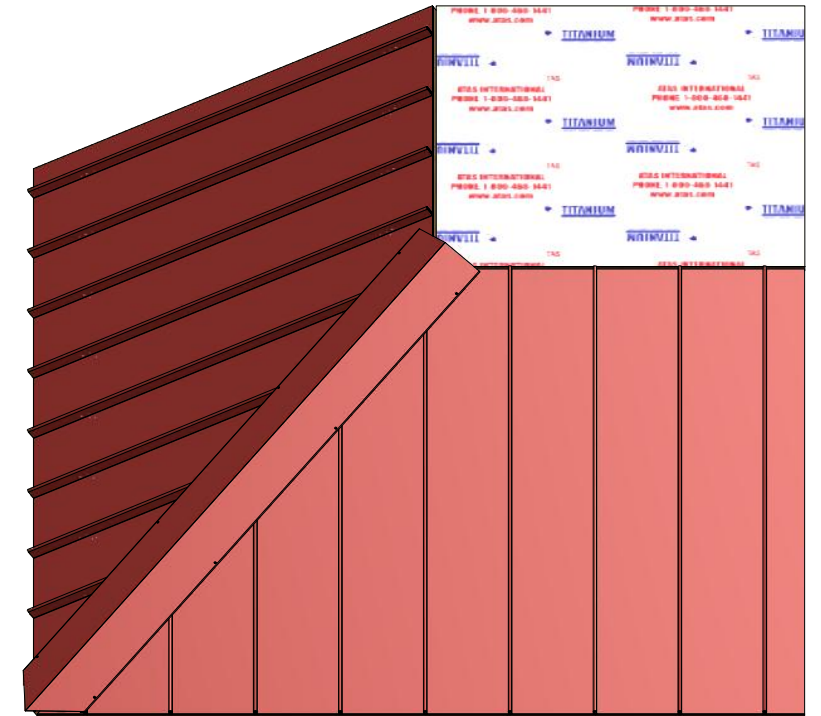

ATAS INTERNATIONAL, INC
 Allentown PA
 610-395-8445
 Mesa AZ
 480-558-7210

TITLE		MRD Hip Detail	
DWG. NO.	DR	DATE	1-20-2014
	KRK	DATE	
MATERIAL	APP	SH. SIZE	B
		SCALE	X:X

REV. NO.	DATE	DESCRIPTION OF REVISION	BY	APP

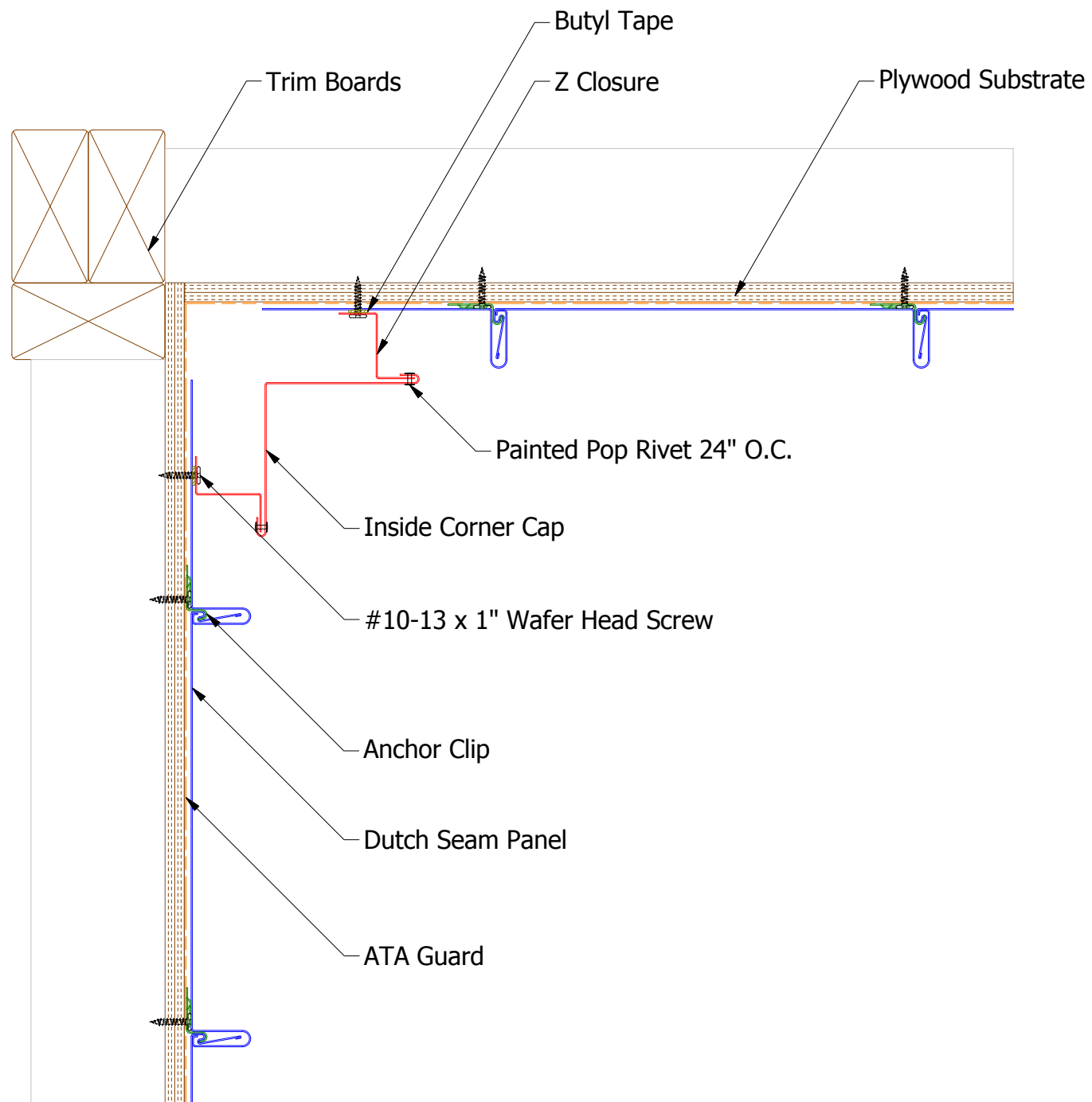

Vertical Application

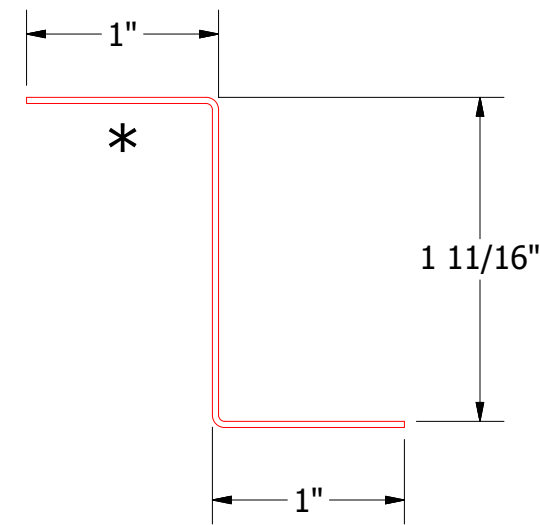

MDA910- Z Closure

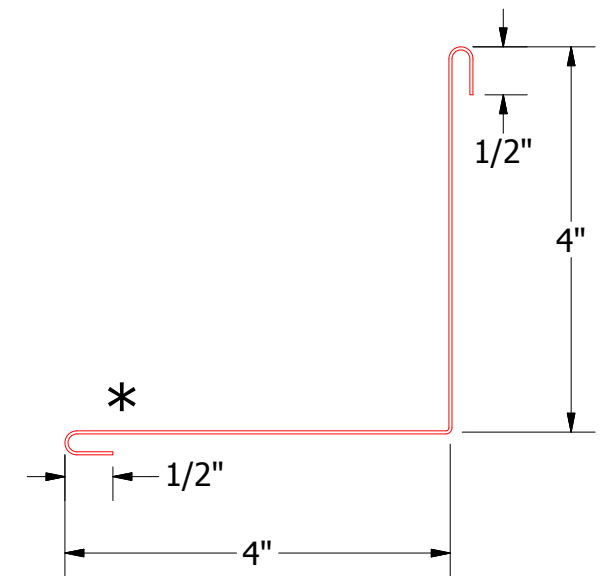

MDA600-Inside Corner Cap

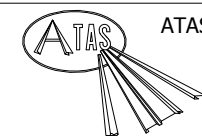

ATAS INTERNATIONAL, INC
 Allentown PA
 610-395-8445
 Mesa AZ
 480-558-7210

TITLE
MRD Inside Corner Detail

REV. NO.	DATE	DESCRIPTION OF REVISION	BY	APP	DWG. NO.	DR	KRK	DATE	1-24-2014
						APP		DATE	
					MATERIAL	SH. SIZE	B	SCALE	X:X

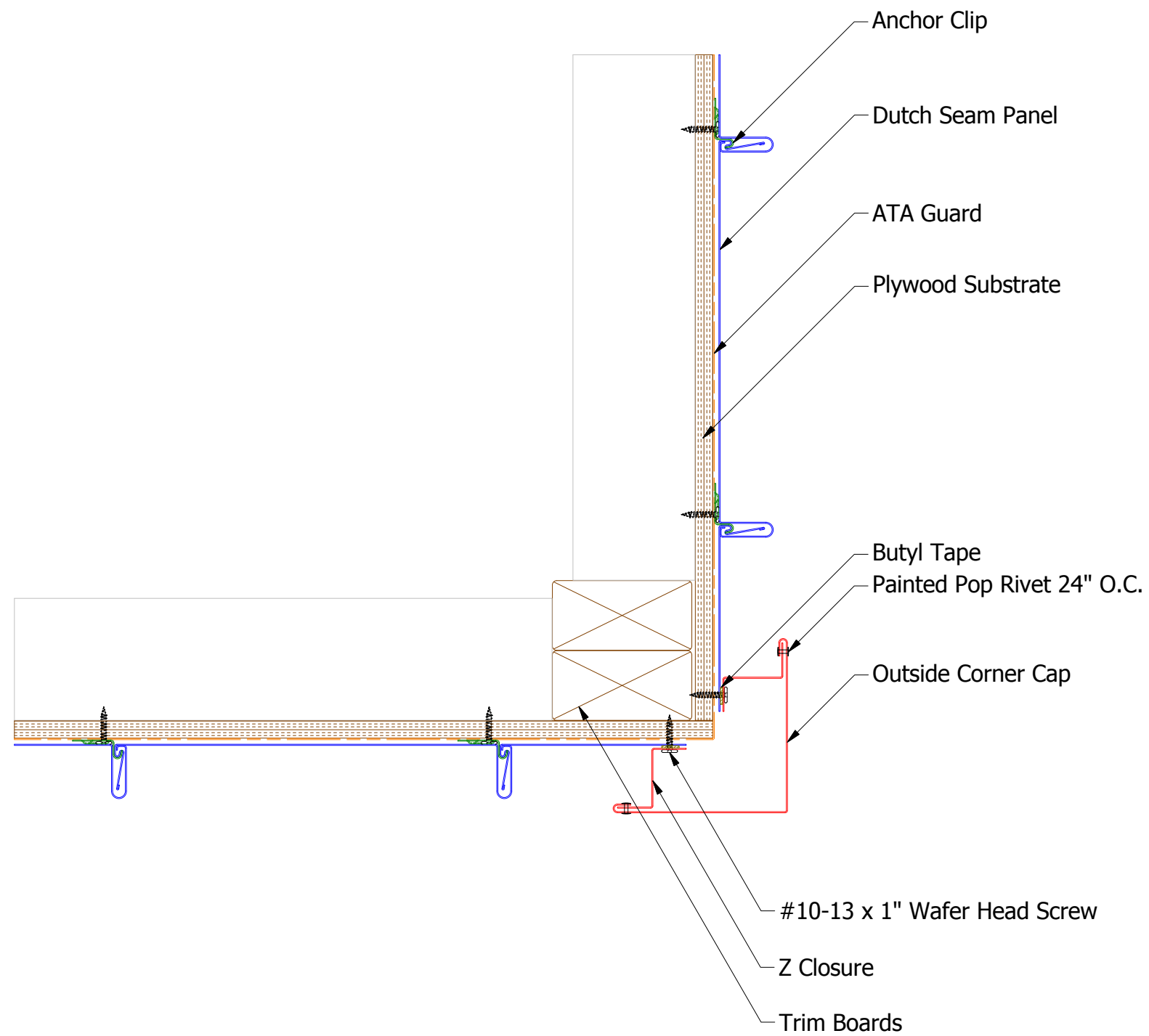

Vertical Application

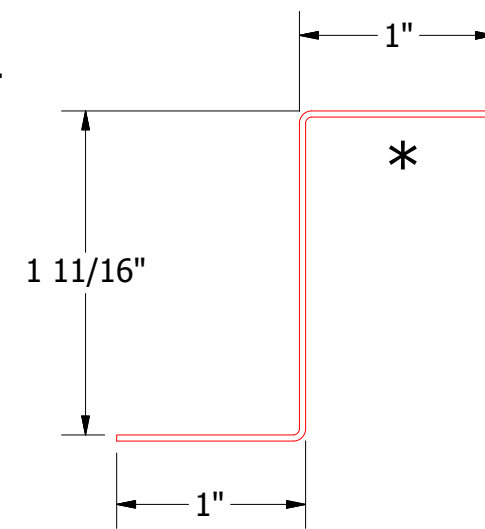
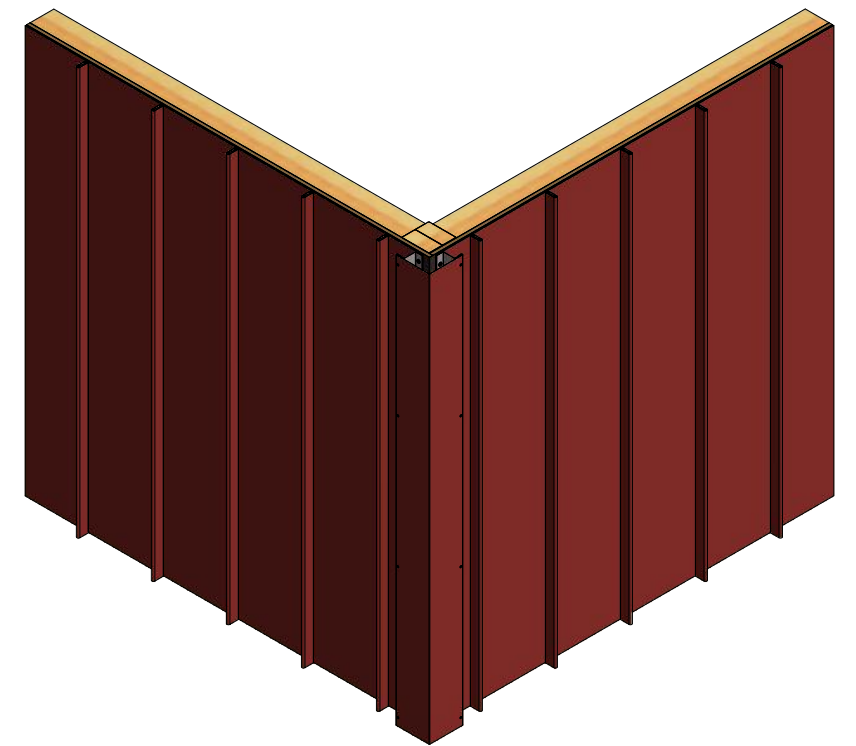

MDA910-Z Closure

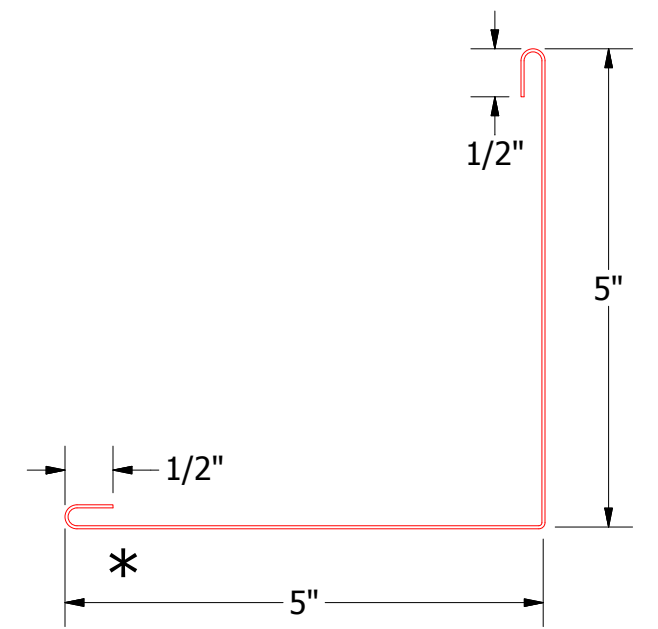

MDA610-Outside Corner Cap

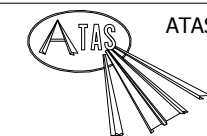

ATAS INTERNATIONAL, INC
 Allentown PA
 610-395-8445
 Mesa AZ
 480-558-7210

TITLE MRD Outside Corner Detail

REV. NO.	DATE	DESCRIPTION OF REVISION	BY	APP	DWG. NO.	DR	DATE
						KRK	1-24-2014
					MATERIAL	APP	DATE
					SH. SIZE	B	SCALE
							X:X

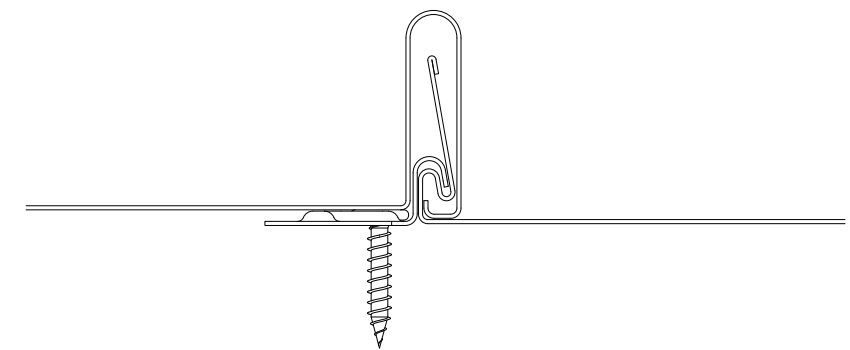
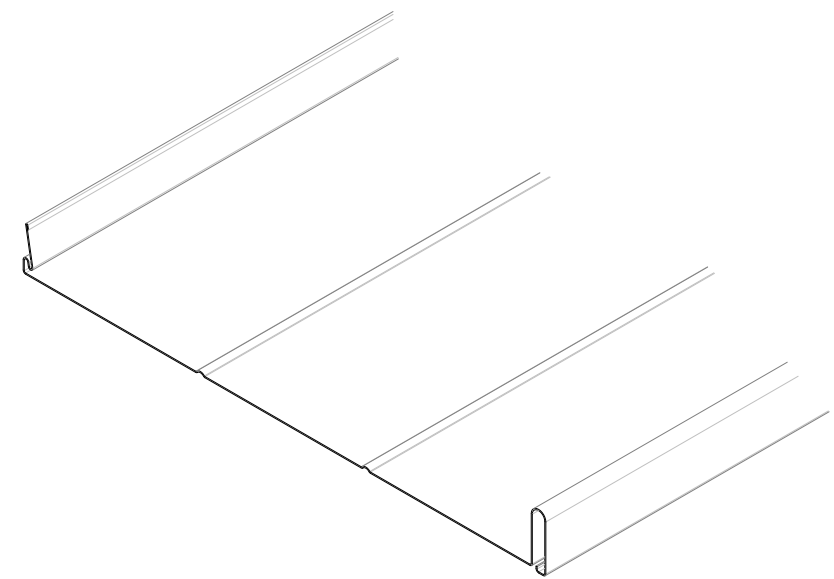
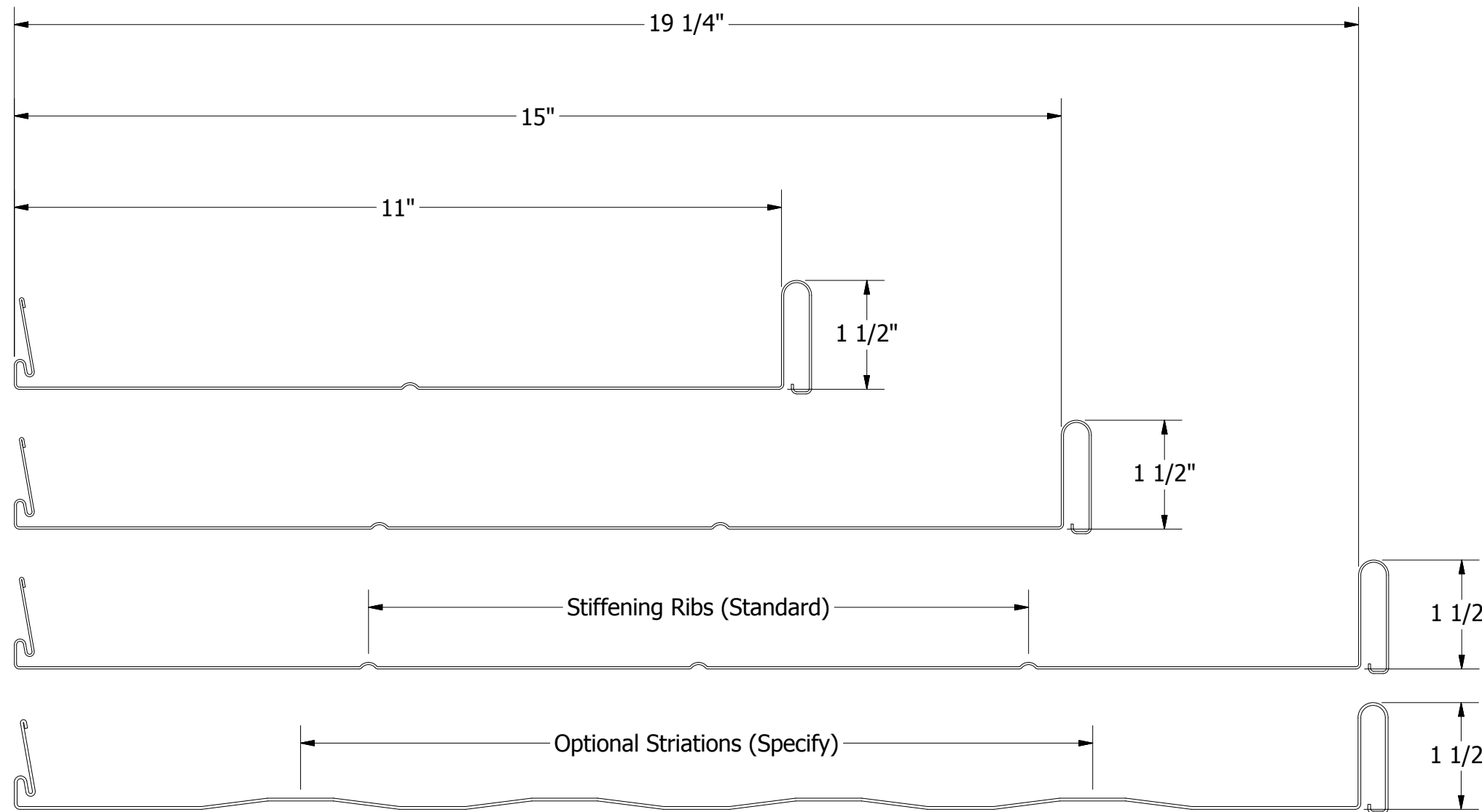

Positive Panel Interlock

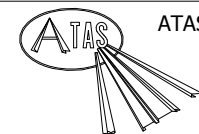

ATAS INTERNATIONAL, INC
 Allentown PA
 610-395-8445
 Mesa AZ
 480-558-7210

TITLE		MRD Panel Profile Detail	
DWG. NO.	DR	DATE	7/17/2014
	KRK	APP	DATE
MATERIAL	SH. SIZE	SCALE	X:X
	B		

REV. NO.	DATE	DESCRIPTION OF REVISION	BY	APP

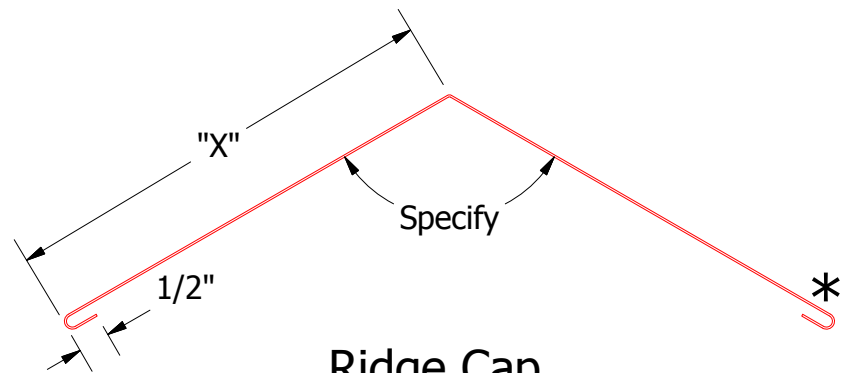

Ridge Cap

- MDA301: 2:12-6:12 Slope
"X"=6"
- MDA302: 6:12-9:12 Slope
"X"=7"
- MDA303: 9:12-12:12 Slope
"X"=8"

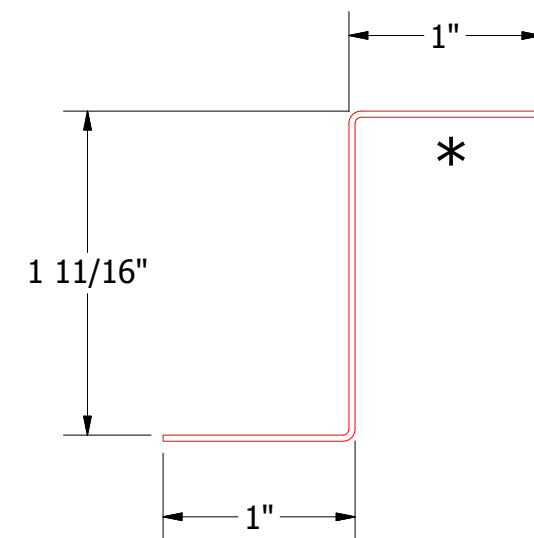
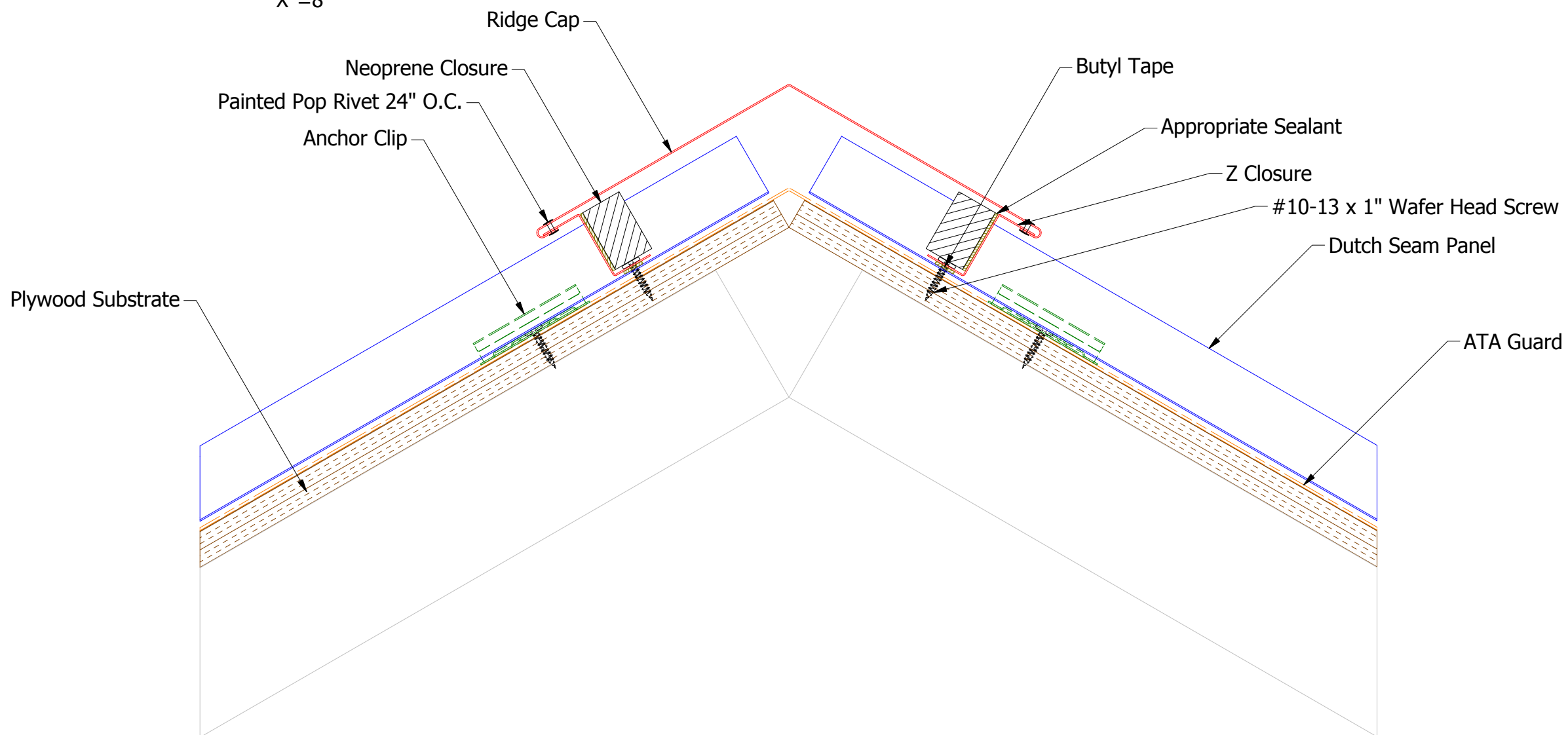
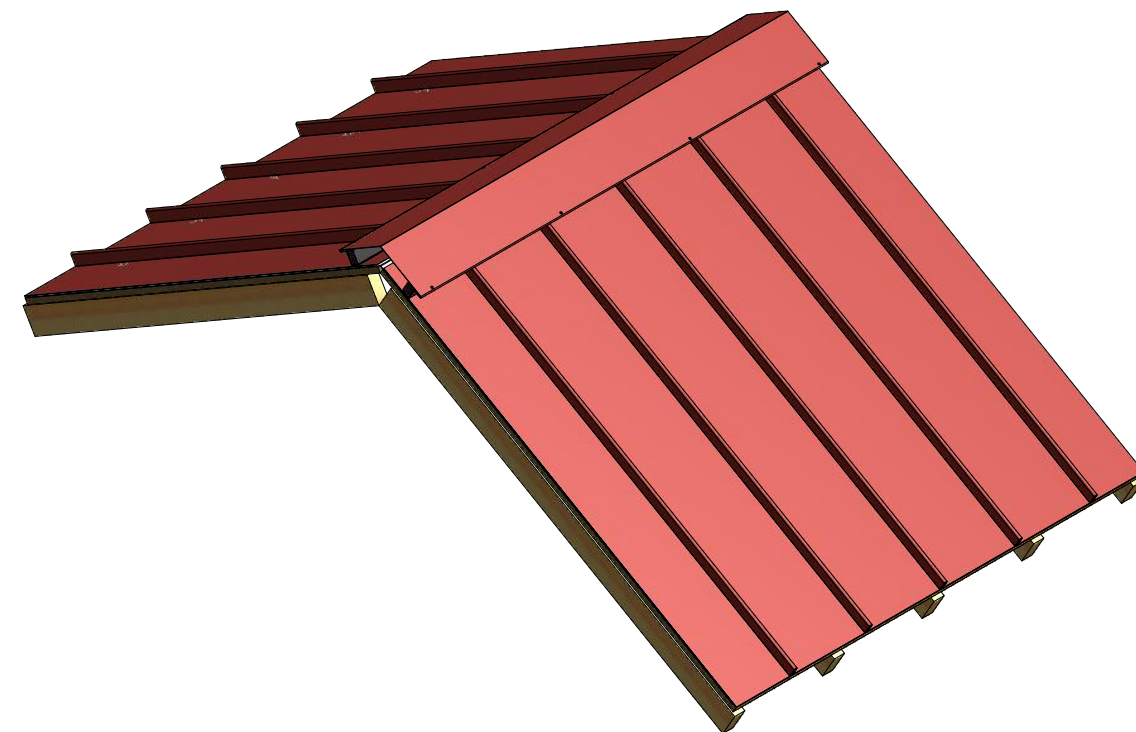

MDA910-Z Closure

Note: Neoprene Closures are not required if Factory Pre Notched Z Closures are utilized.

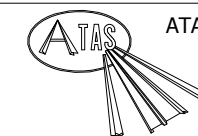

ATAS INTERNATIONAL, INC
Allentown PA
610-395-8445
Mesa AZ
480-558-7210

TITLE				MRD Ridge Detail	
DWG. NO.		DR		DATE	
		KRK		1-24-2014	
MATERIAL		APP		DATE	
		SH. SIZE		SCALE	
		B		X:X	
REV. NO.	DATE	DESCRIPTION OF REVISION	BY	APP	

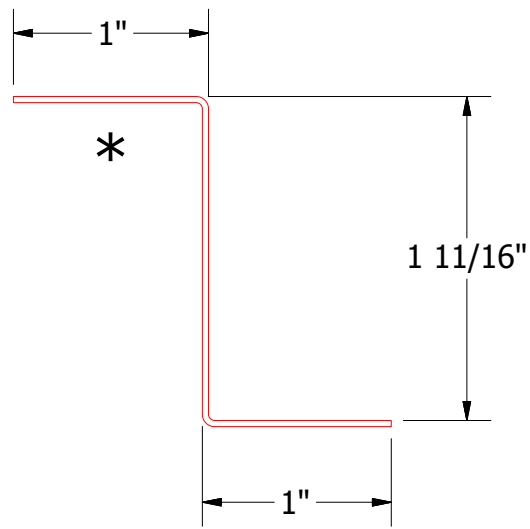

MDA910-Z Closure

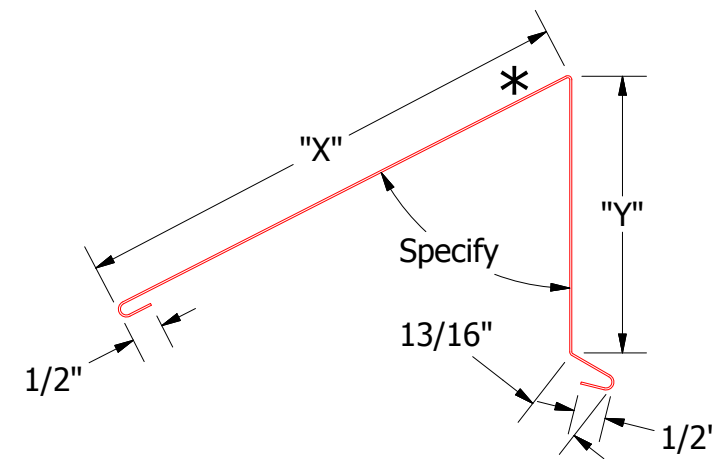
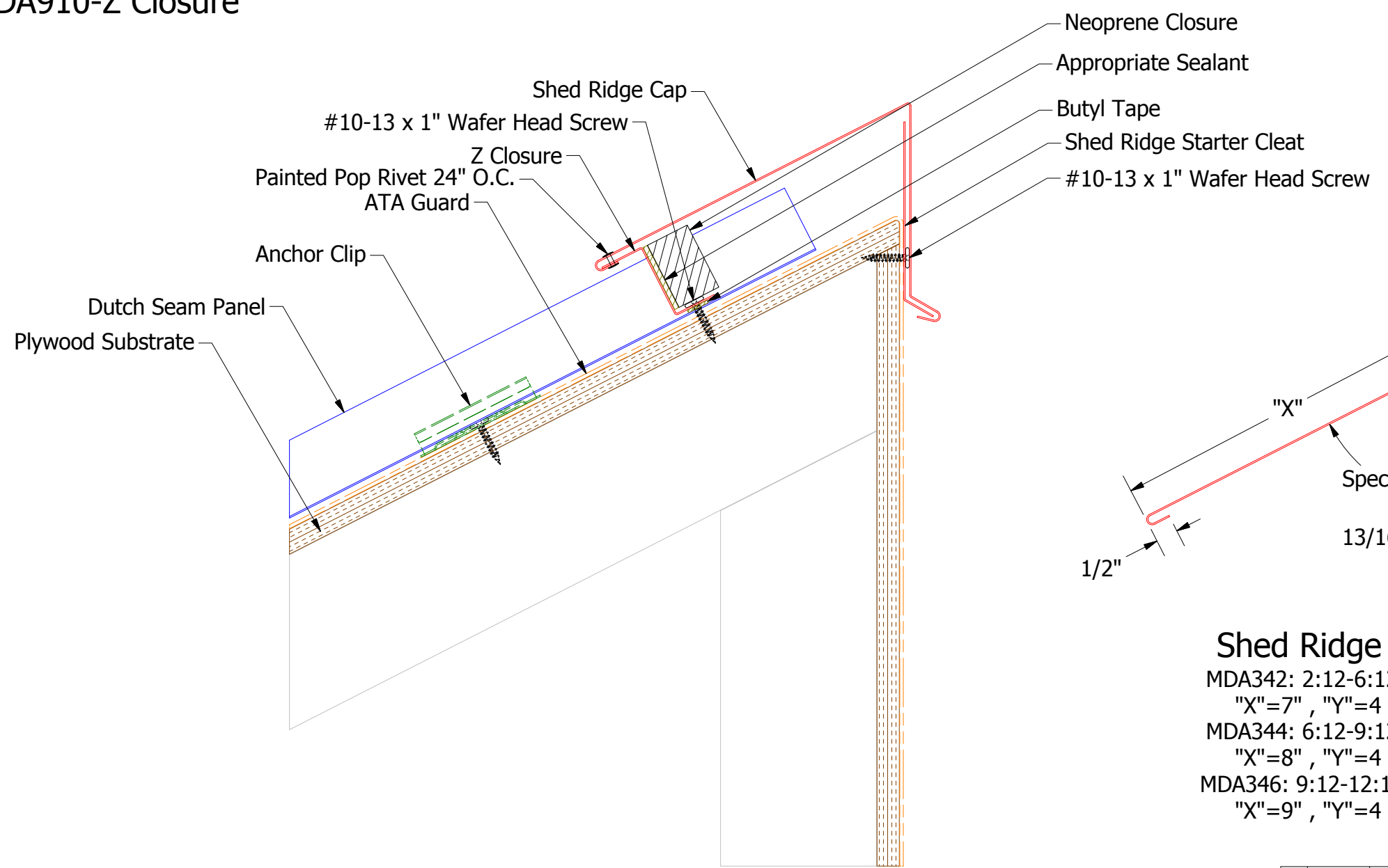
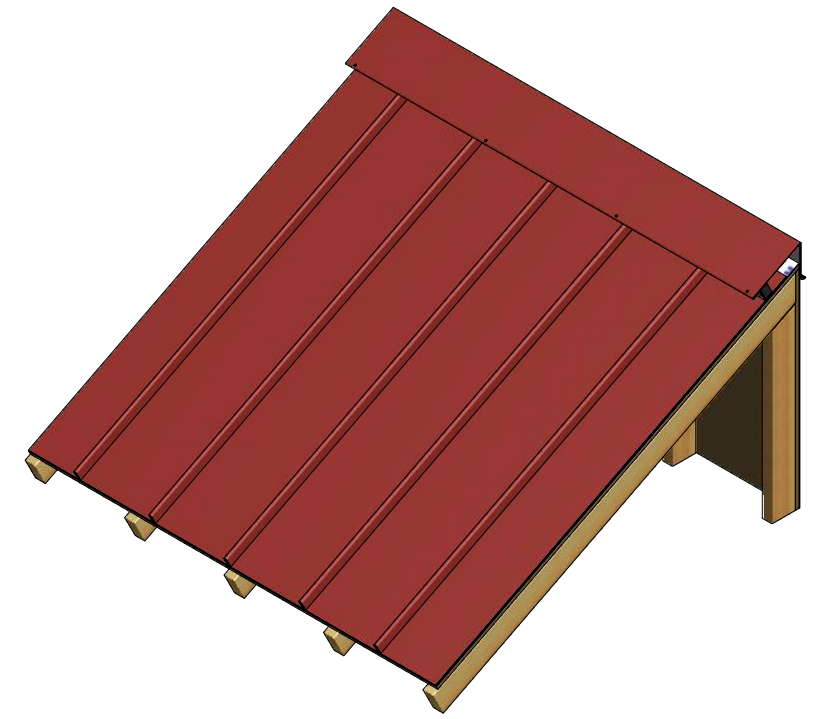

Shed Ridge Cap
 MDA342: 2:12-6:12 Slope
 "X"=7" , "Y"=4 1/8"
 MDA344: 6:12-9:12 Slope
 "X"=8" , "Y"=4 3/8"
 MDA346: 9:12-12:12 Slope
 "X"=9" , "Y"=4 1/2"

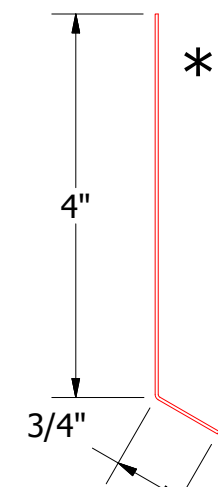

Shed Ridge Starter Cleat
 MDA341: For use with MDA342 Shed Ridge Cap
 MDA348: For use with MDA344 Shed Ridge Cap
 MDA349: For use with MDA346 Shed Ridge Cap

Note: Neoprene Closures are not required if Factory Pre Notched Z Closures are utilized.

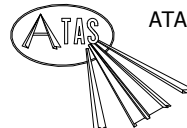
 ATAS INTERNATIONAL, INC Allentown PA 610-395-8445 Mesa AZ 480-558-7210		TITLE	
		MRD Shed Ridge Detail	
DWG. NO.	DR	DATE	
	KRK	1-24-2014	
MATERIAL	APP	DATE	
REV. NO.	DATE	DESCRIPTION OF REVISION	BY APP
	SH. SIZE	B	SCALE X:X

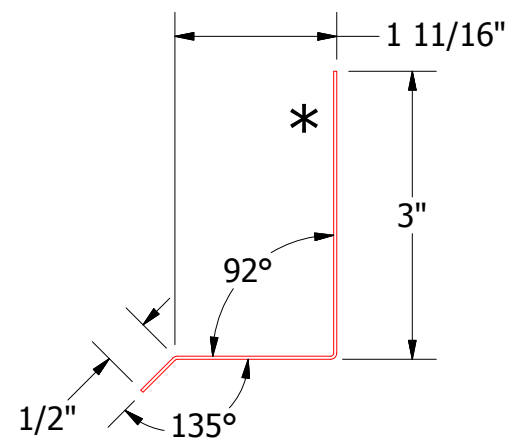

MDA660-Plain Sill Trim

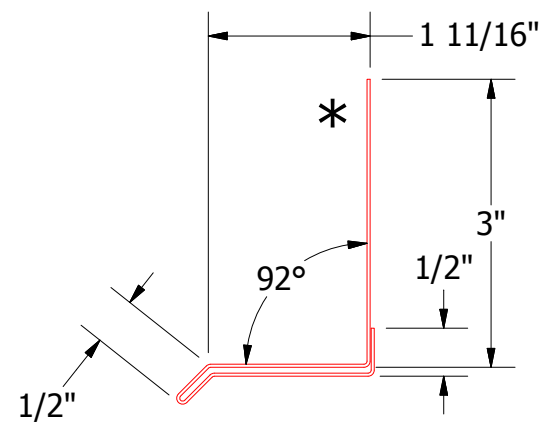

MDA661-Sill Trim with Return

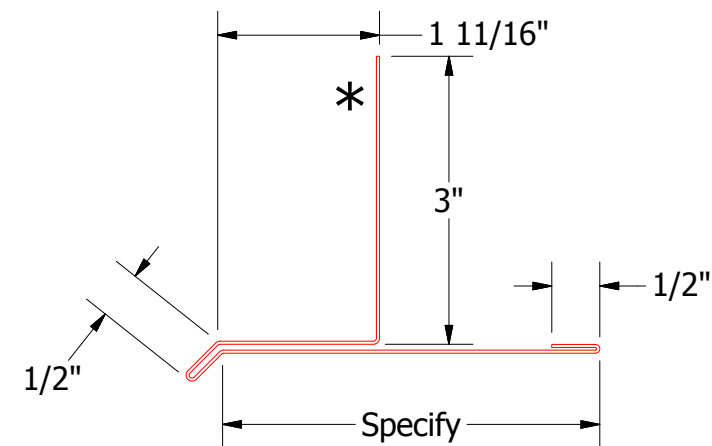

MDA662-T Sill Trim

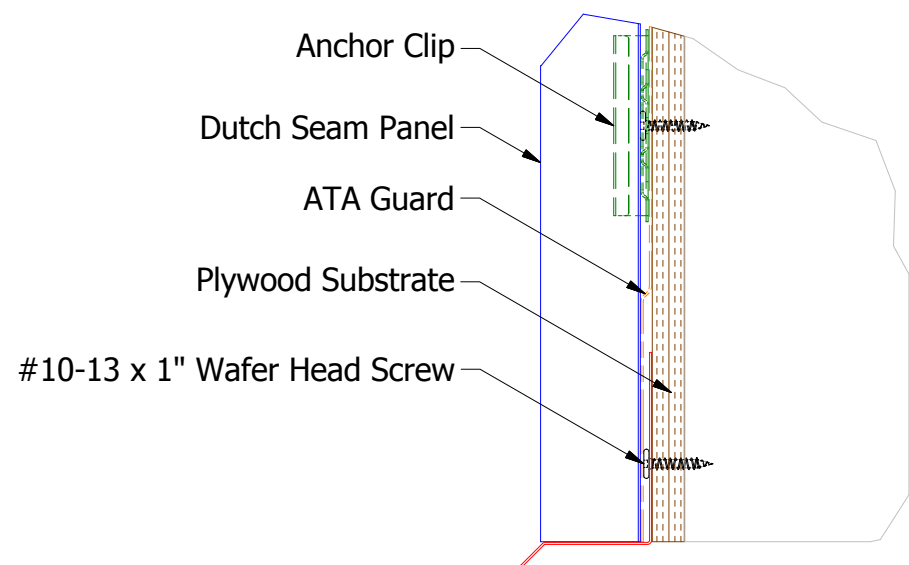
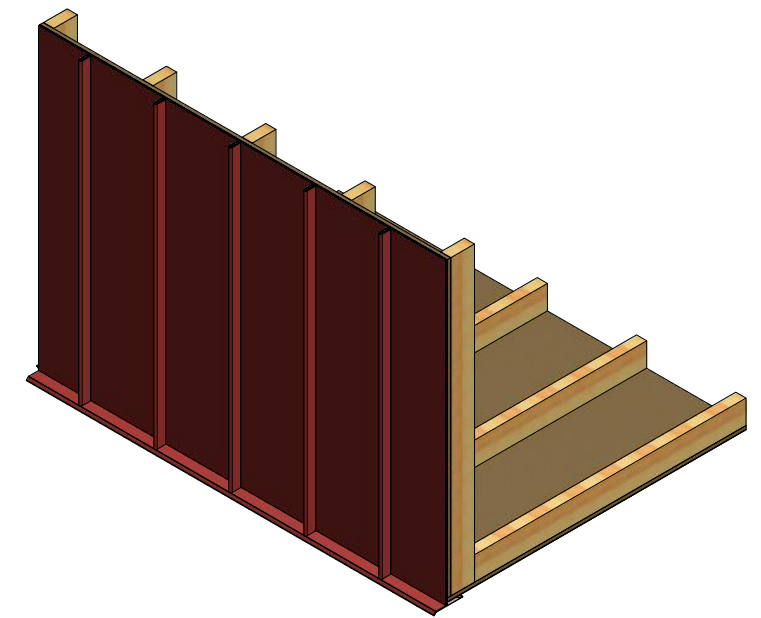

DETAIL A

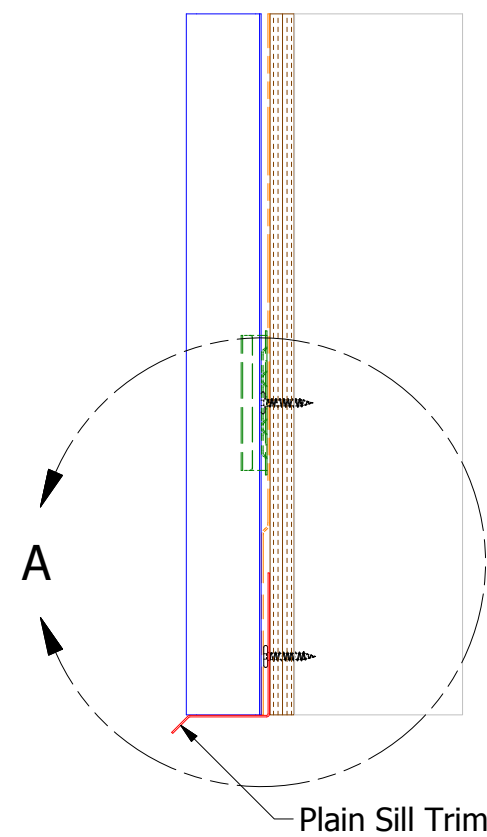

Plain Sill Trim

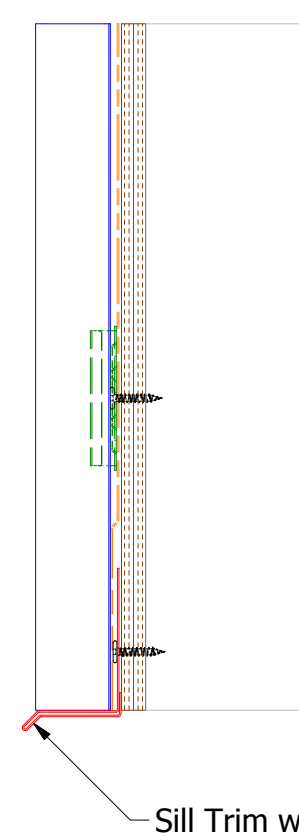

Sill Trim with Return

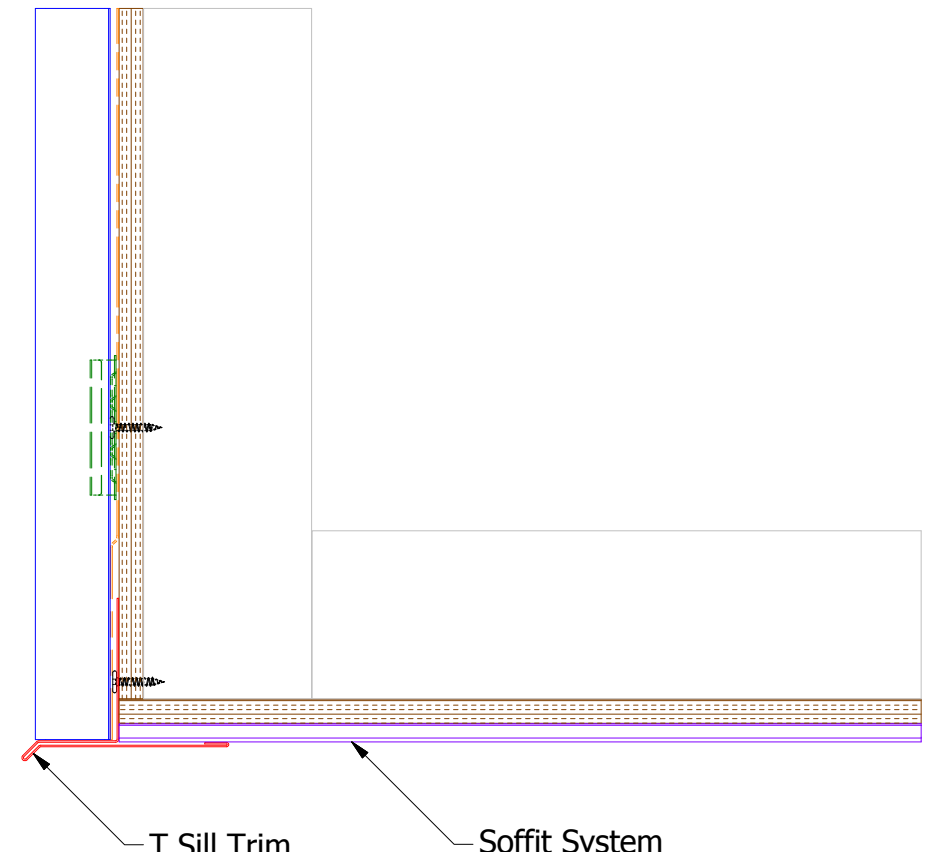

T Sill Trim

Soffit System

Vertical Application

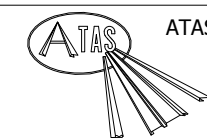

ATAS INTERNATIONAL, INC
 Allentown PA
 610-395-8445
 Mesa AZ
 480-558-7210

TITLE		MRD Sill Trim Detail	
DWG. NO.	DR	DATE	1-27-2014
	KRK	DATE	
MATERIAL	APP	SH. SIZE	B
REV. NO.	DATE	DESCRIPTION OF REVISION	SCALE X:X

REV. NO.	DATE	DESCRIPTION OF REVISION	BY	APP

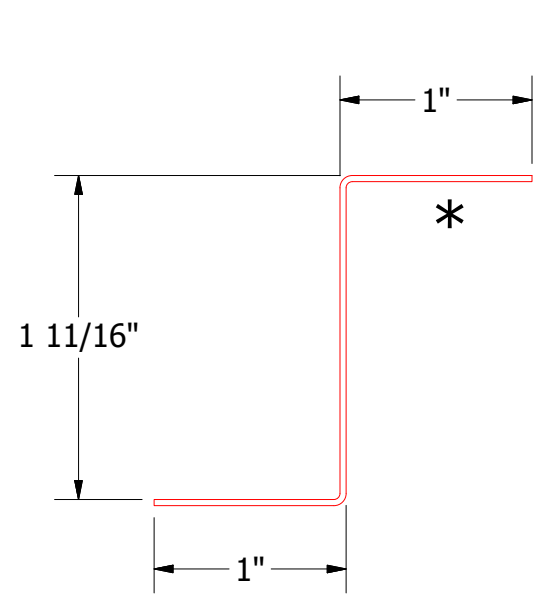

MDA910-Z Closure

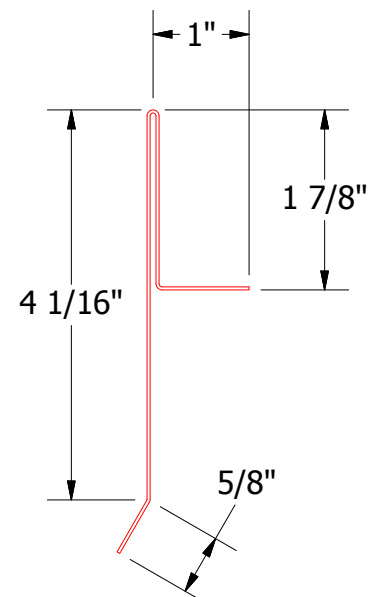

MDA211-Gable Trim Starter Cleat

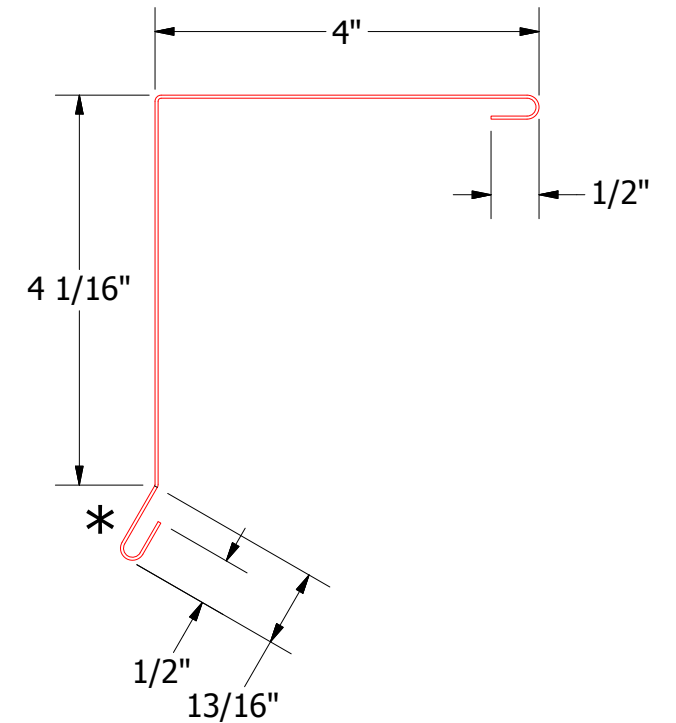
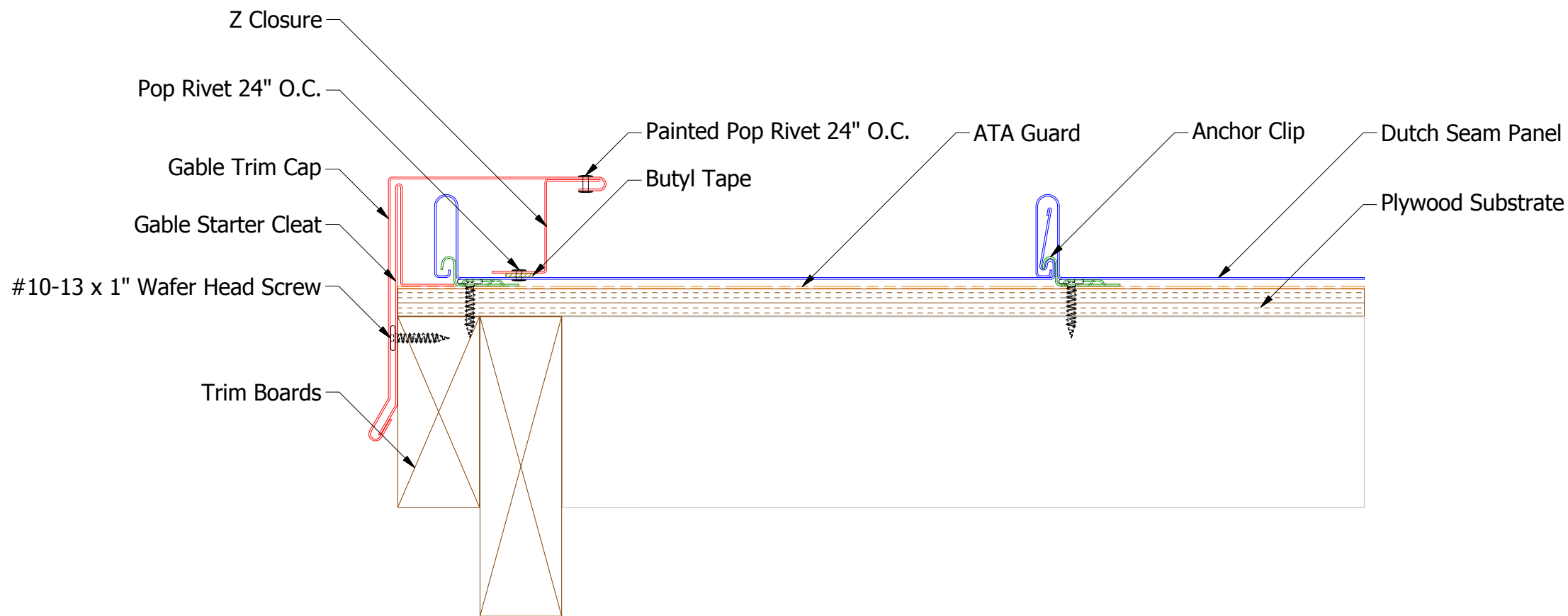
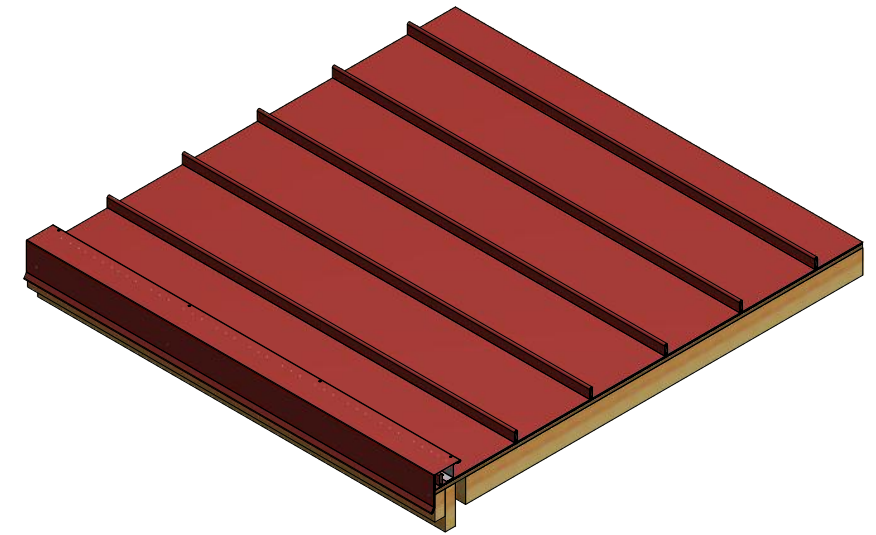

MDA210-Gable Trim Cap

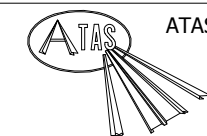

ATAS INTERNATIONAL, INC
 Allentown PA
 610-395-8445
 Mesa AZ
 480-558-7210

TITLE				MRD Starting Gable Detail			
DWG. NO.		DR		DATE		DATE	
		KRK		1-27-2014			
MATERIAL		APP		DATE			
REV. NO.		DATE		DESCRIPTION OF REVISION		BY APP	
						SH. SIZE B SCALE X:X	

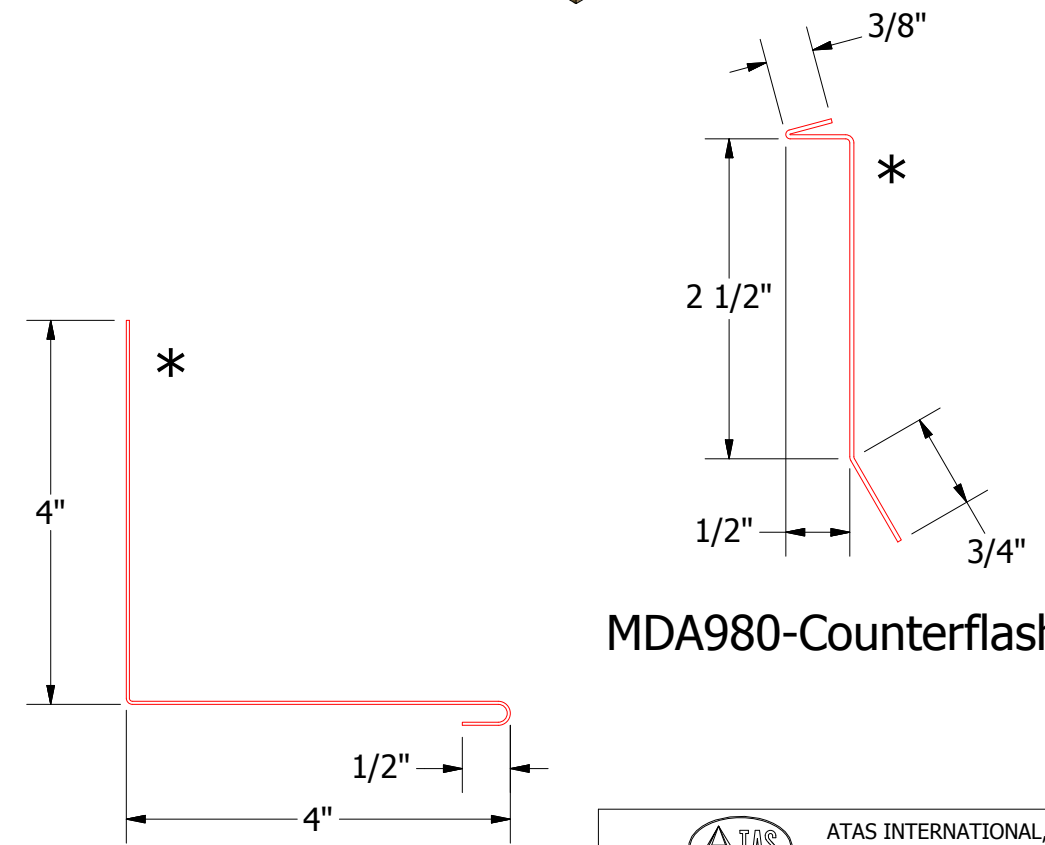
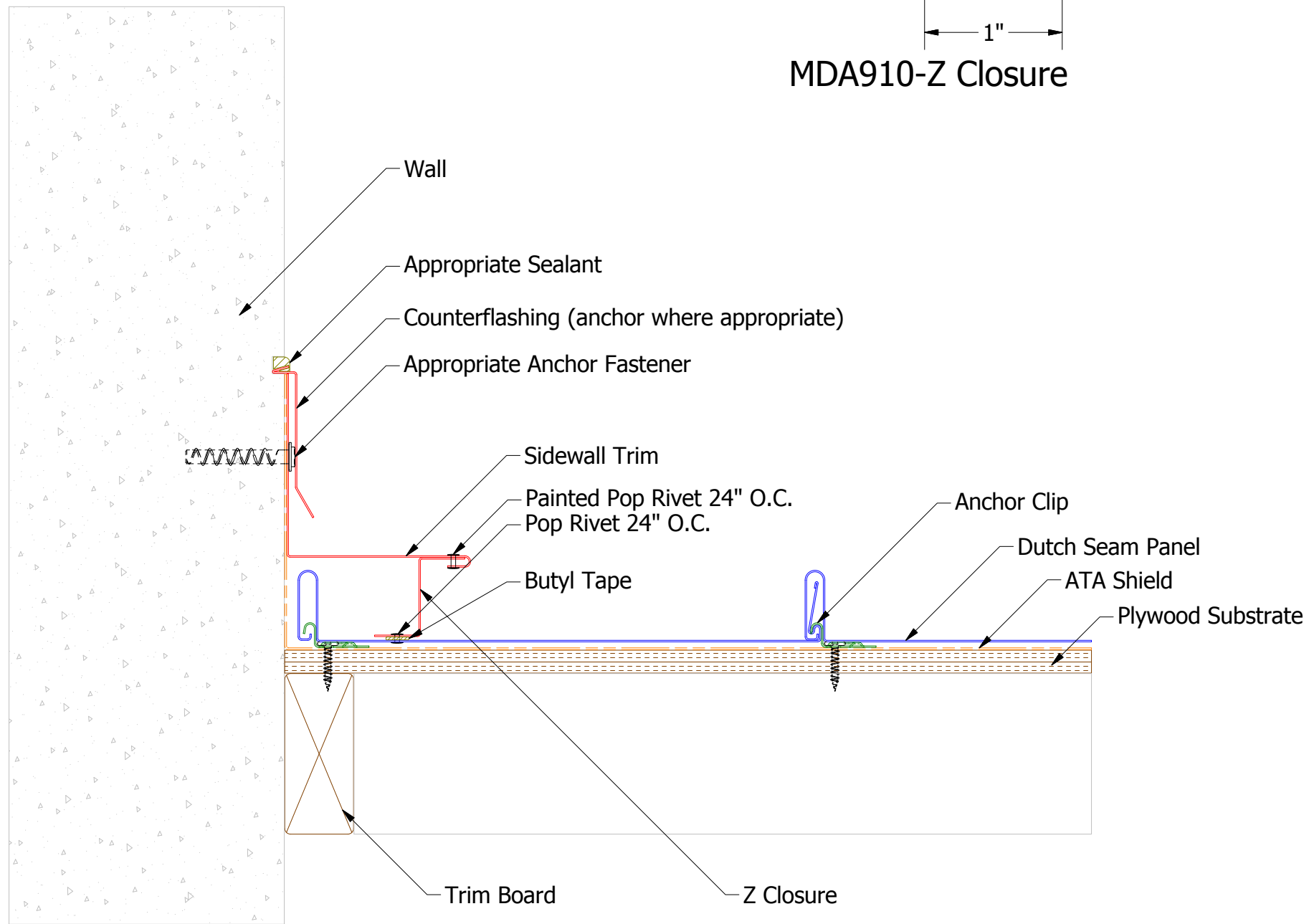
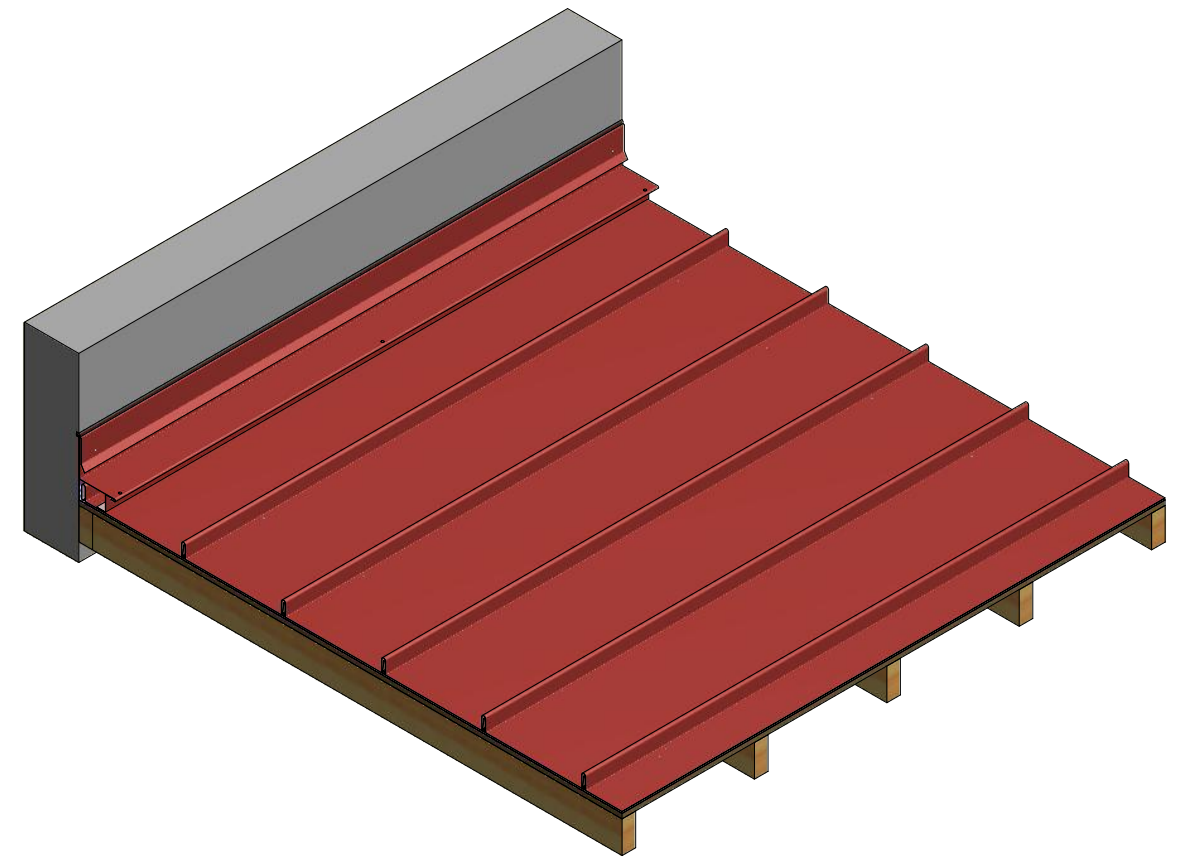
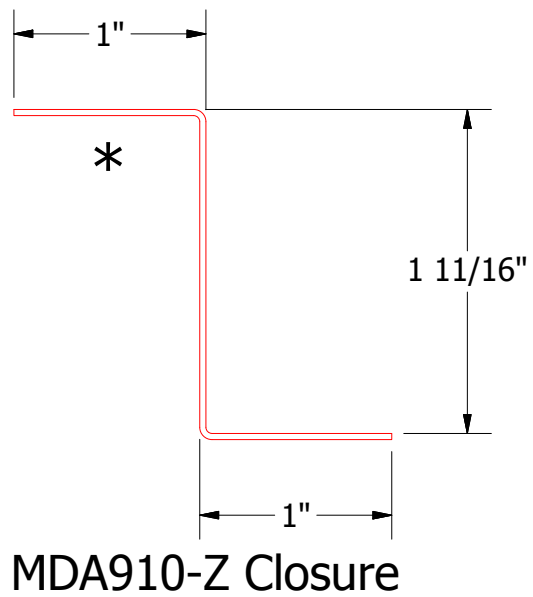

ATAS ATAS INTERNATIONAL, INC
 Allentown PA
 610-395-8445
 Mesa AZ
 480-558-7210

TITLE				MRD Starting Rake Sidewall Detail	
DWG. NO.		DR		DATE	
		KRK		1-29-2014	
MATERIAL		APP		DATE	
		SH. SIZE		SCALE	
		B		X:X	

REV. NO.	DATE	DESCRIPTION OF REVISION	BY	APP

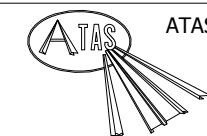
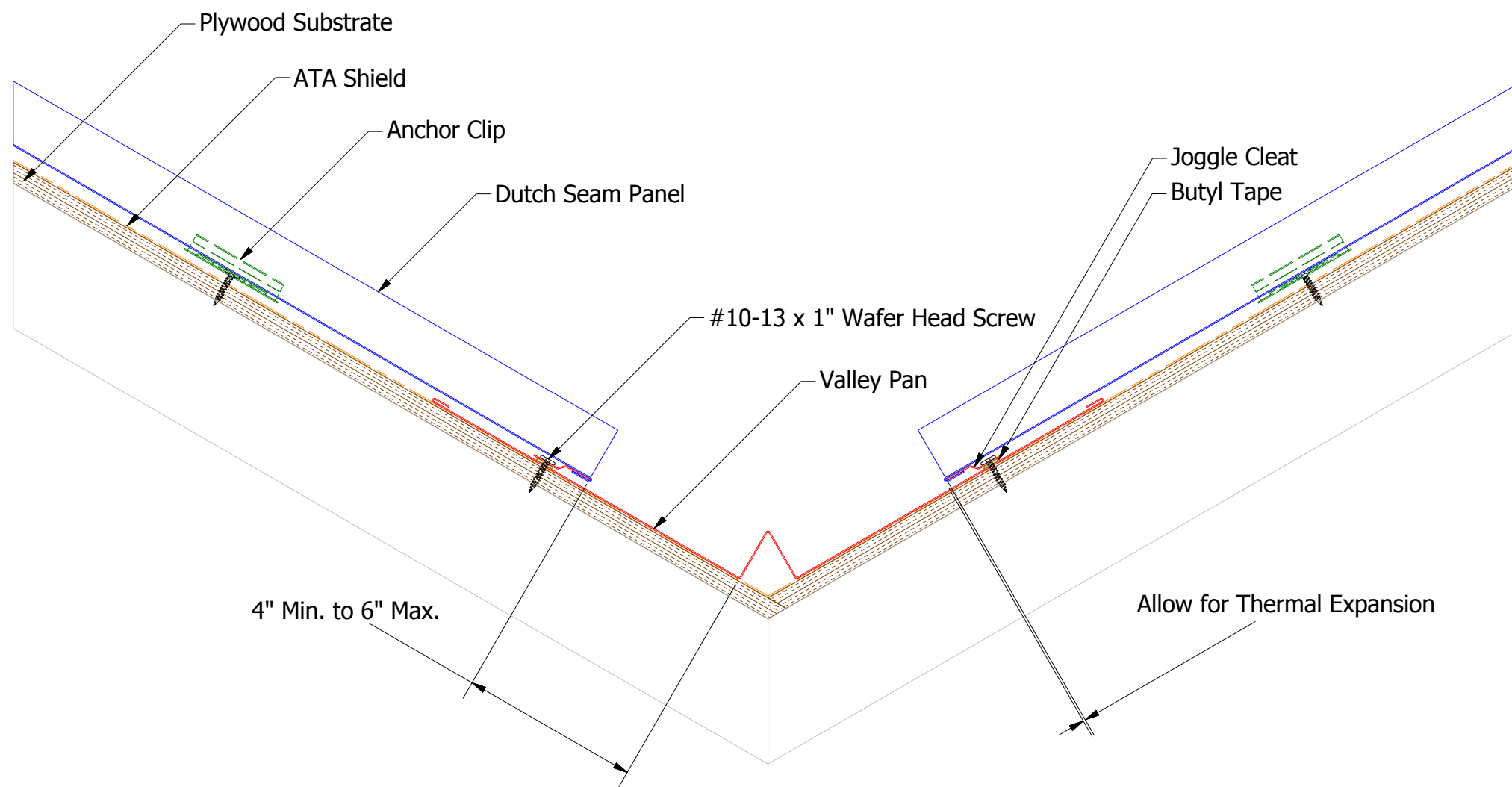
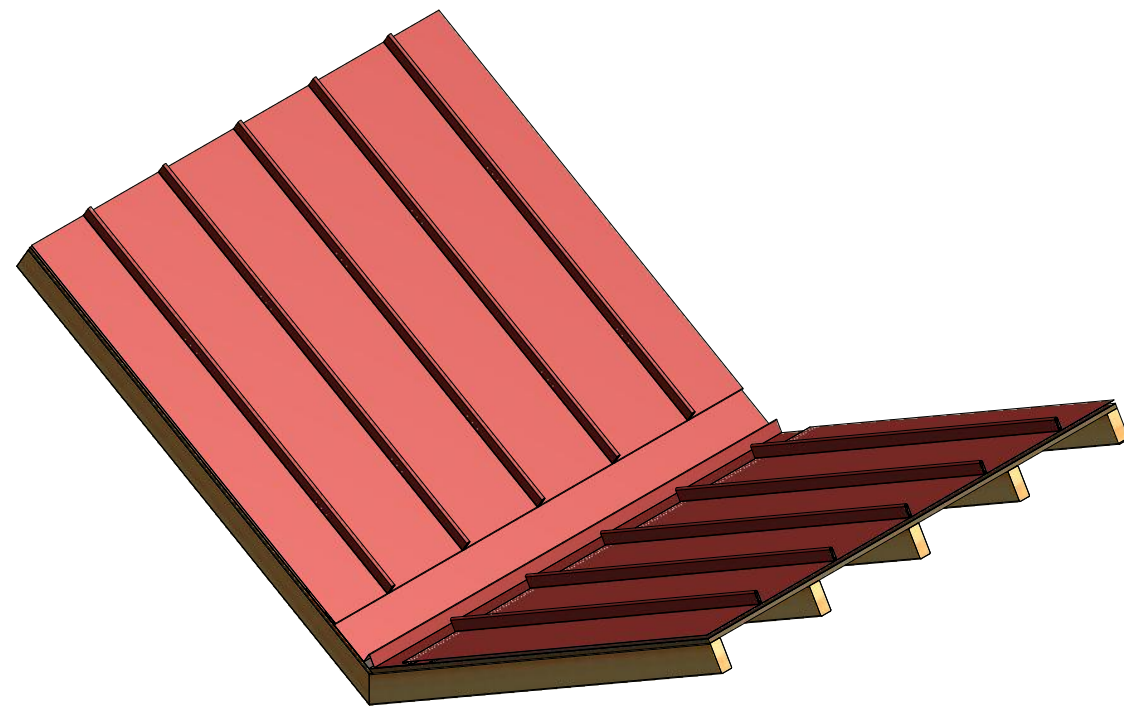
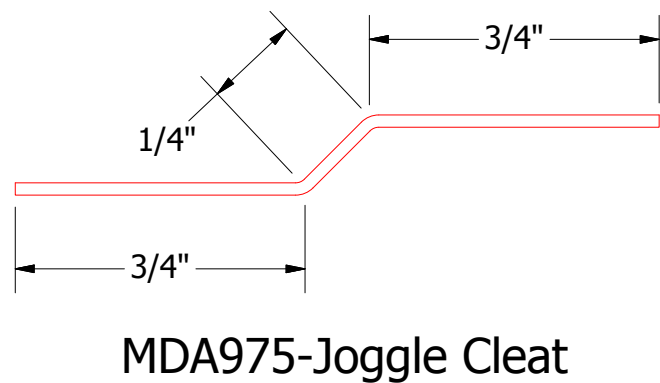
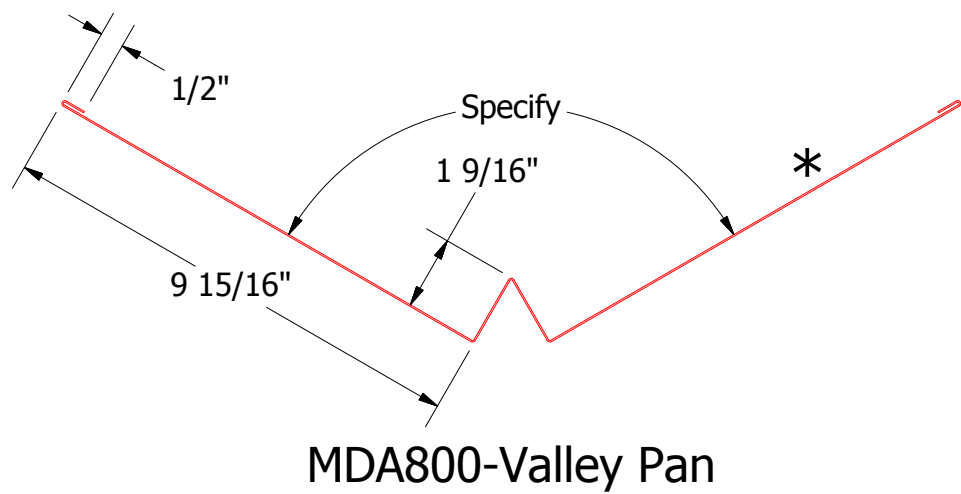

ATAS INTERNATIONAL, INC
 Allentown PA
 610-395-8445
 Mesa AZ
 480-558-7210

TITLE		MRD Valley Detail	
DWG. NO.	DR	DATE	
	KRK	1-29-2014	
MATERIAL	APP	DATE	
	SH. SIZE	B	SCALE X:X

REV. NO.	DATE	DESCRIPTION OF REVISION	BY	APP

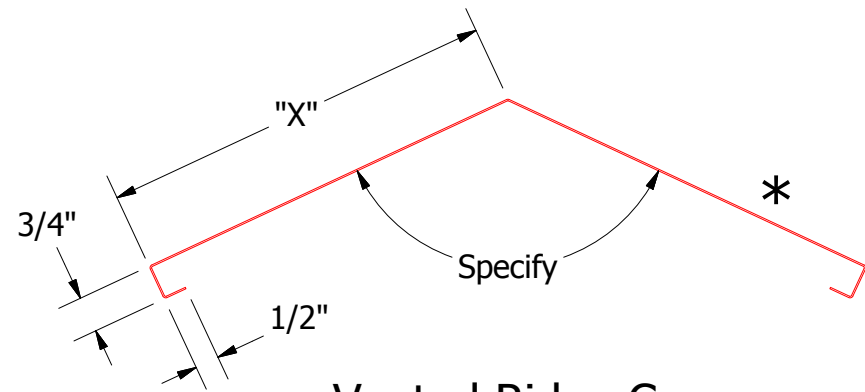

Vented Ridge Cap

MDA332: 2:12-6:12 Slope

"X" = 7 1/4"

MDA334: 6:12-9:12 Slope

"X" = 8 1/4"

MDA336: 9:12-12:12 Slope

"X" = 9 1/4"

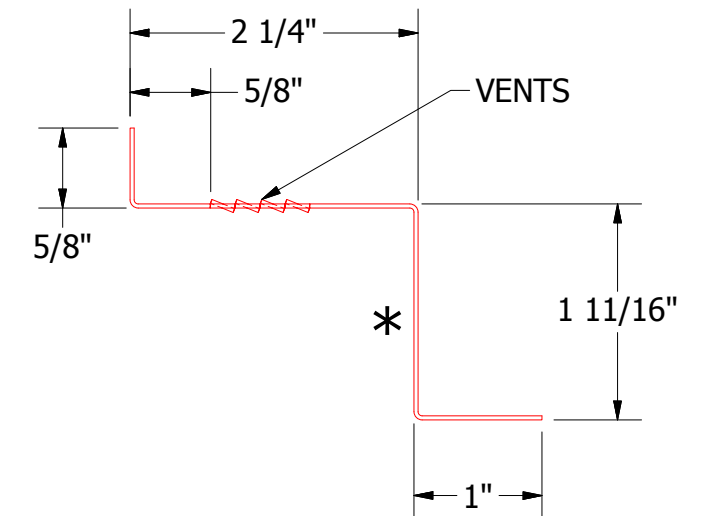
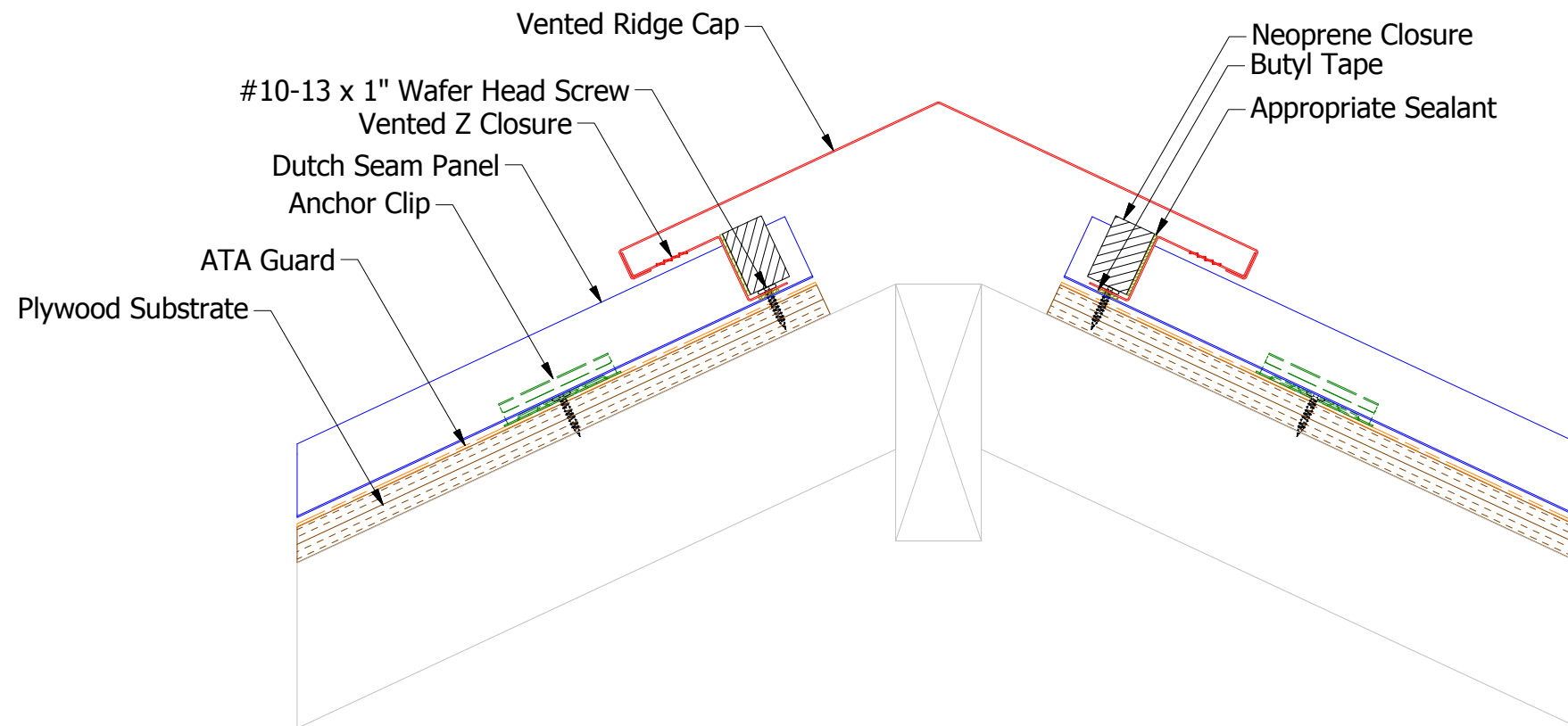

MDA911-Vented Z Closure

Note: Neoprene Closures are not required if Factory Vented Pre Notched Z Closures are utilized.



ATAS INTERNATIONAL, INC
 Allentown PA
 610-395-8445
 Mesa AZ
 480-558-7210

TITLE				MRD Vented Ridge Detail	
DWG. NO.		DR		DATE	
		KRK		1-29-2014	
MATERIAL		APP		DATE	
		SH. SIZE		SCALE	
		B		X:X	
REV. NO.	DATE	DESCRIPTION OF REVISION	BY	APP	

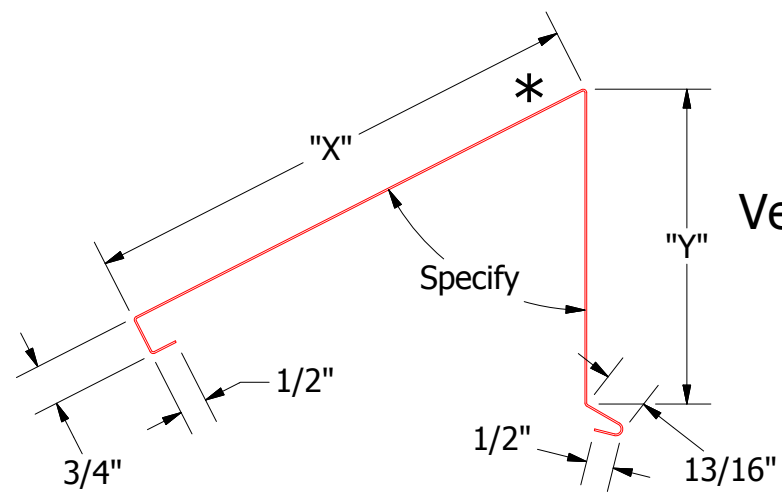

Vented Shed Ridge Cap

- MDA362: 2:12-6:12 Slope
"X"=8 1/4" , "Y"=5 1/2"
- MDA364: 6:12-9:12 Slope
"X"=9 1/4" , "Y"=5 3/4"
- MDA366: 9:12-12:12 Slope
"X"=10 1/4" , "Y"=6"



Vented Shed Ridge Starter Cleat

- MDA361: 2:12-6:12 Slope
"Z"=5 3/8"
- MDA368: 6:12-9:12 Slope
"Z"=5 5/8"
- MDA369: 9:12-12:12 Slope
"Z"=5 7/8"

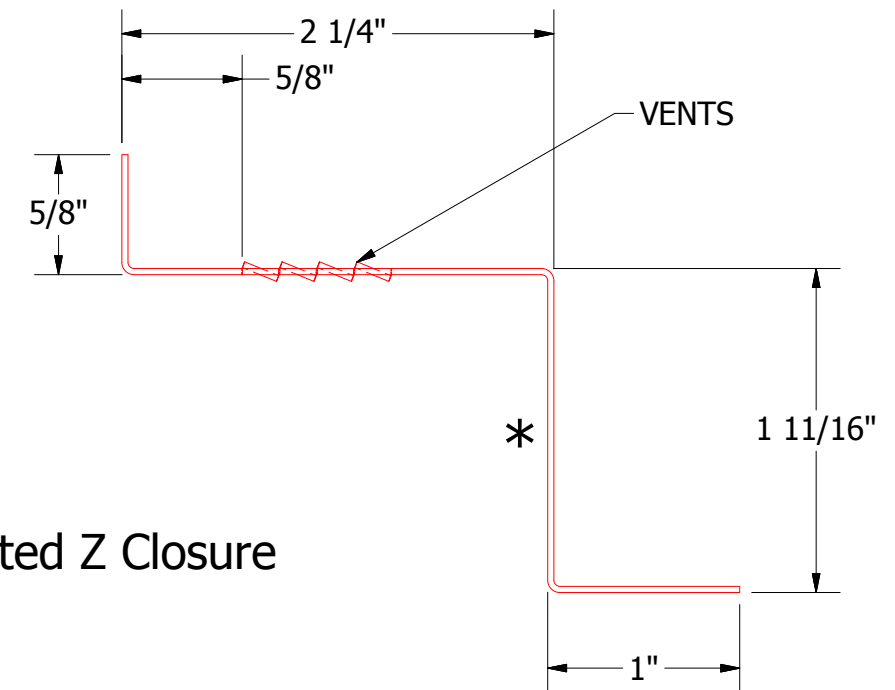
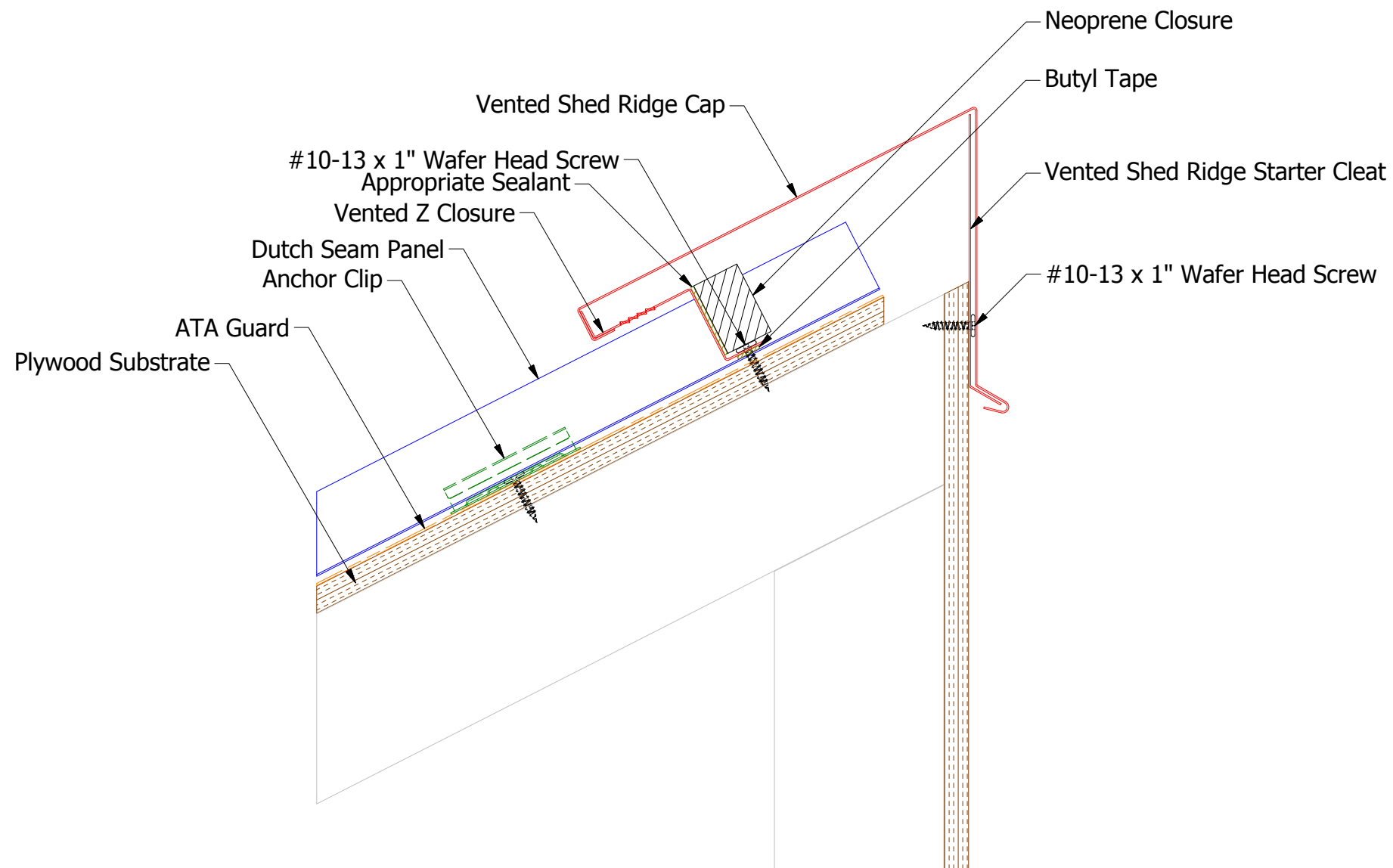
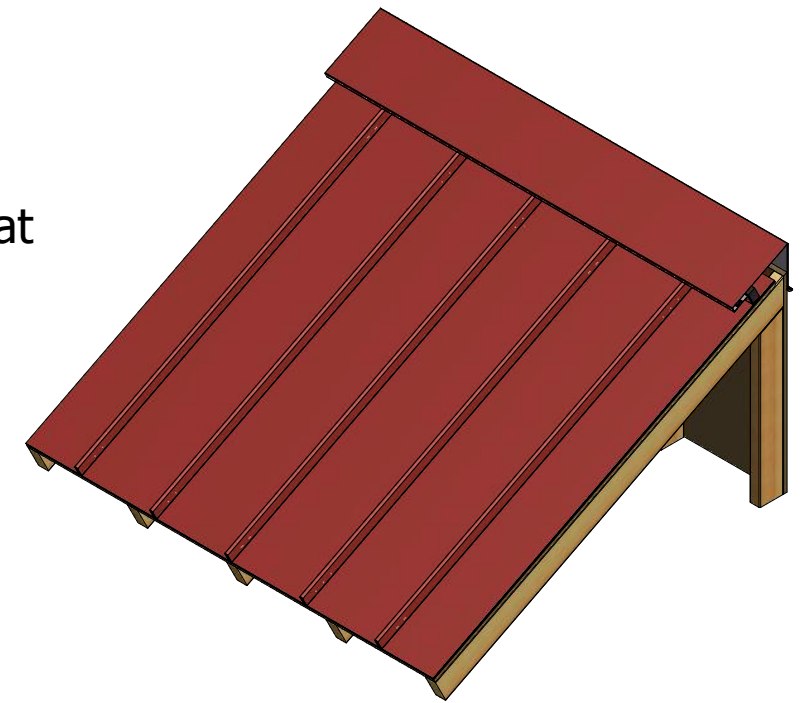

MDA911-Vented Z Closure

Note: Neoprene Closures are not required if Factory Vented Pre Notched Z Closures are utilized.

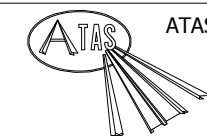

ATAS INTERNATIONAL, INC
Allentown PA
610-395-8445
Mesa AZ
480-558-7210

REV. NO.		DATE		DESCRIPTION OF REVISION		BY	APP	TITLE MRD Vented Shed Ridge Detail	
DWG. NO.		DR		DATE		APP		DATE	
MATERIAL		SH. SIZE		SCALE		B		X:X	

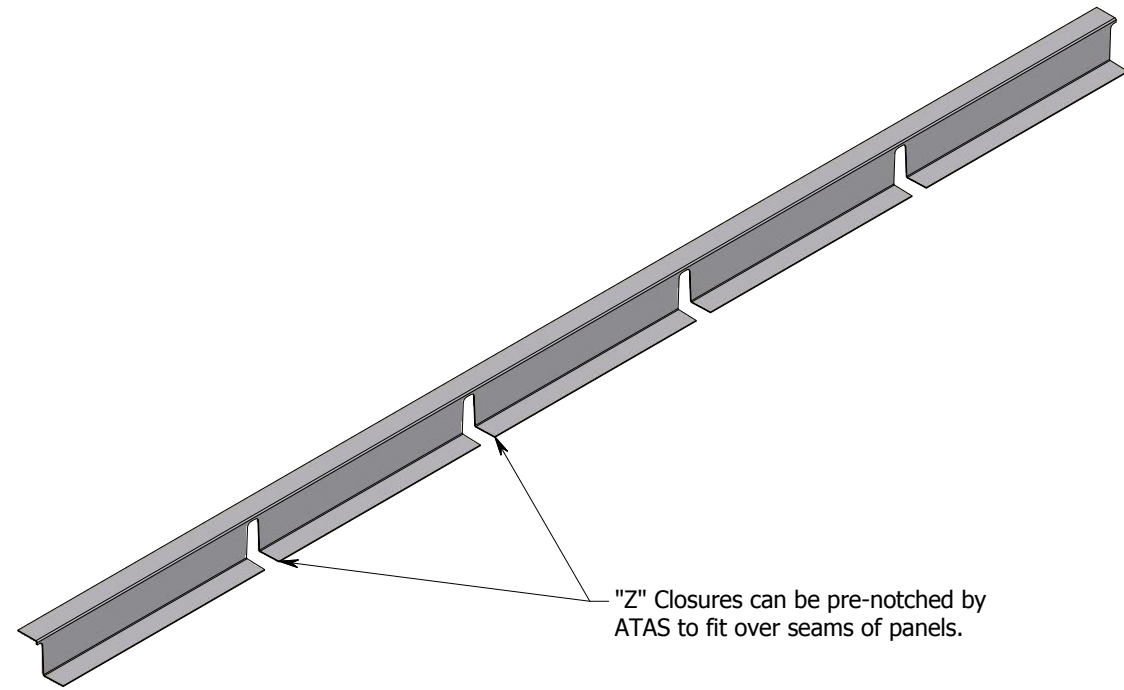

"Z" Closures can be pre-notched by ATAS to fit over seams of panels.

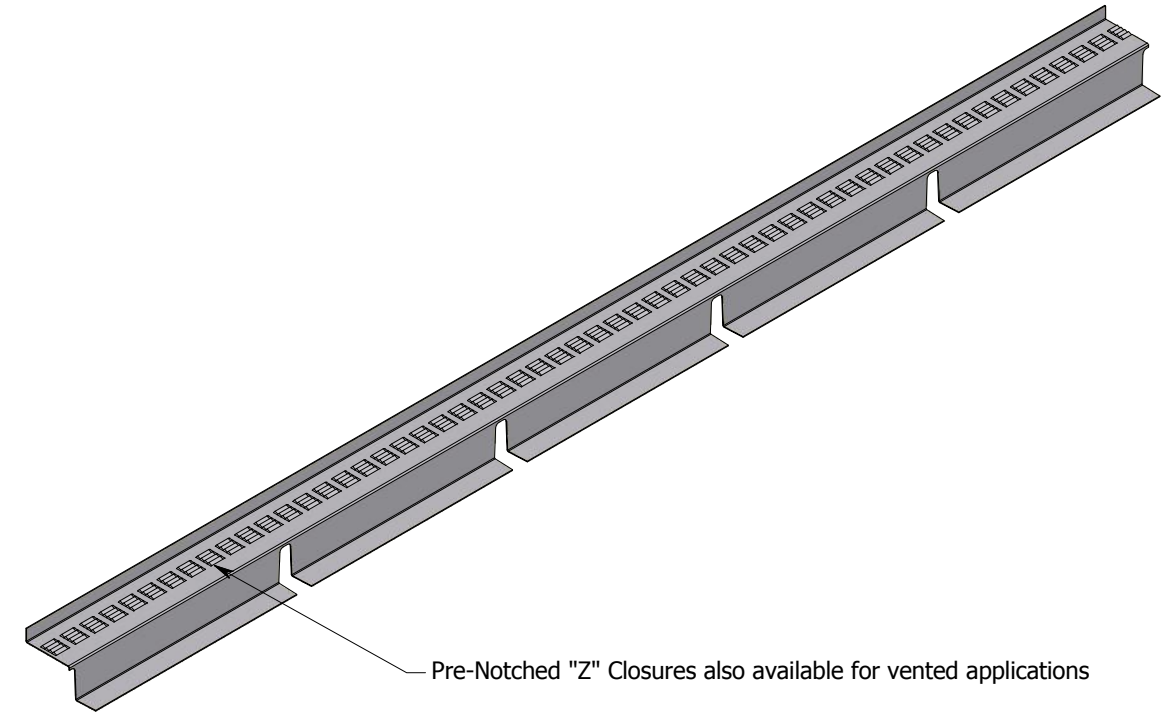

Pre-Notched "Z" Closures also available for vented applications

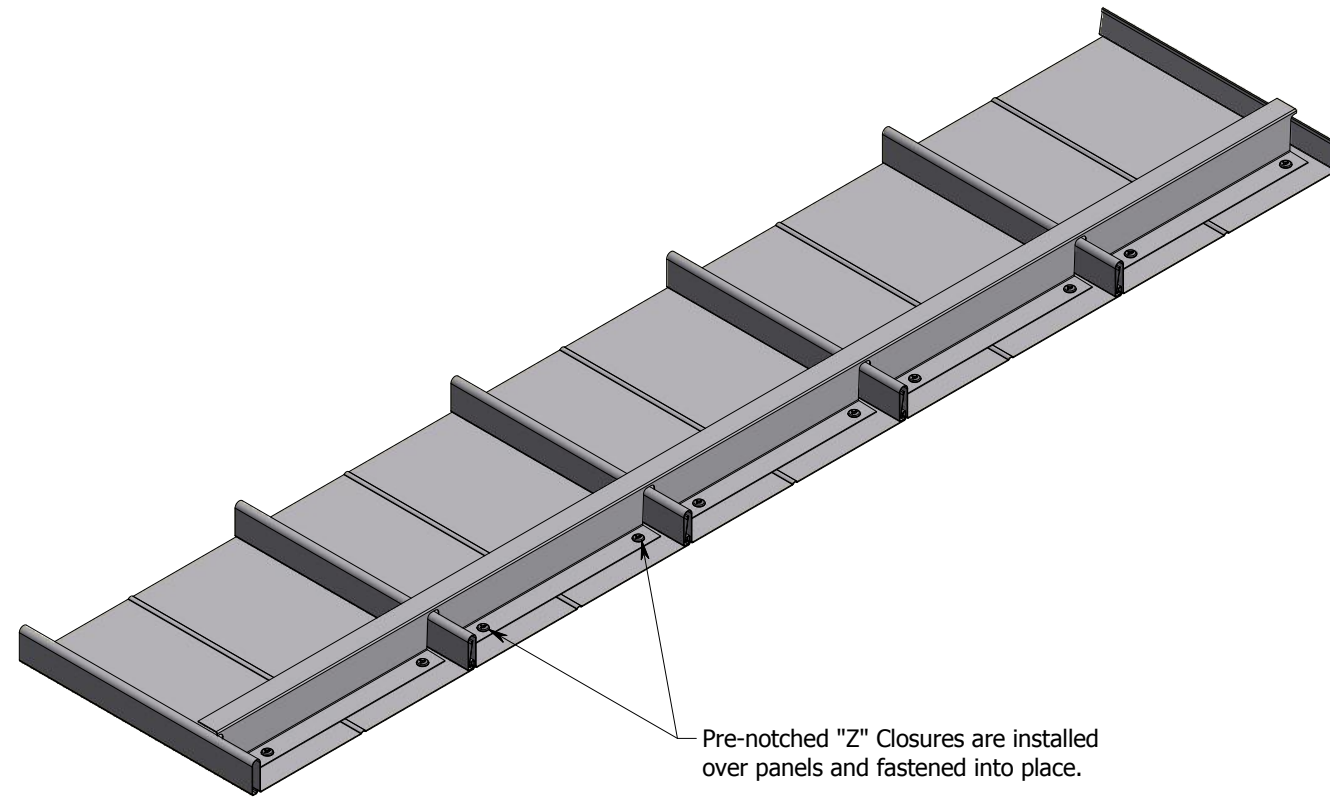

Pre-notched "Z" Closures are installed over panels and fastened into place.

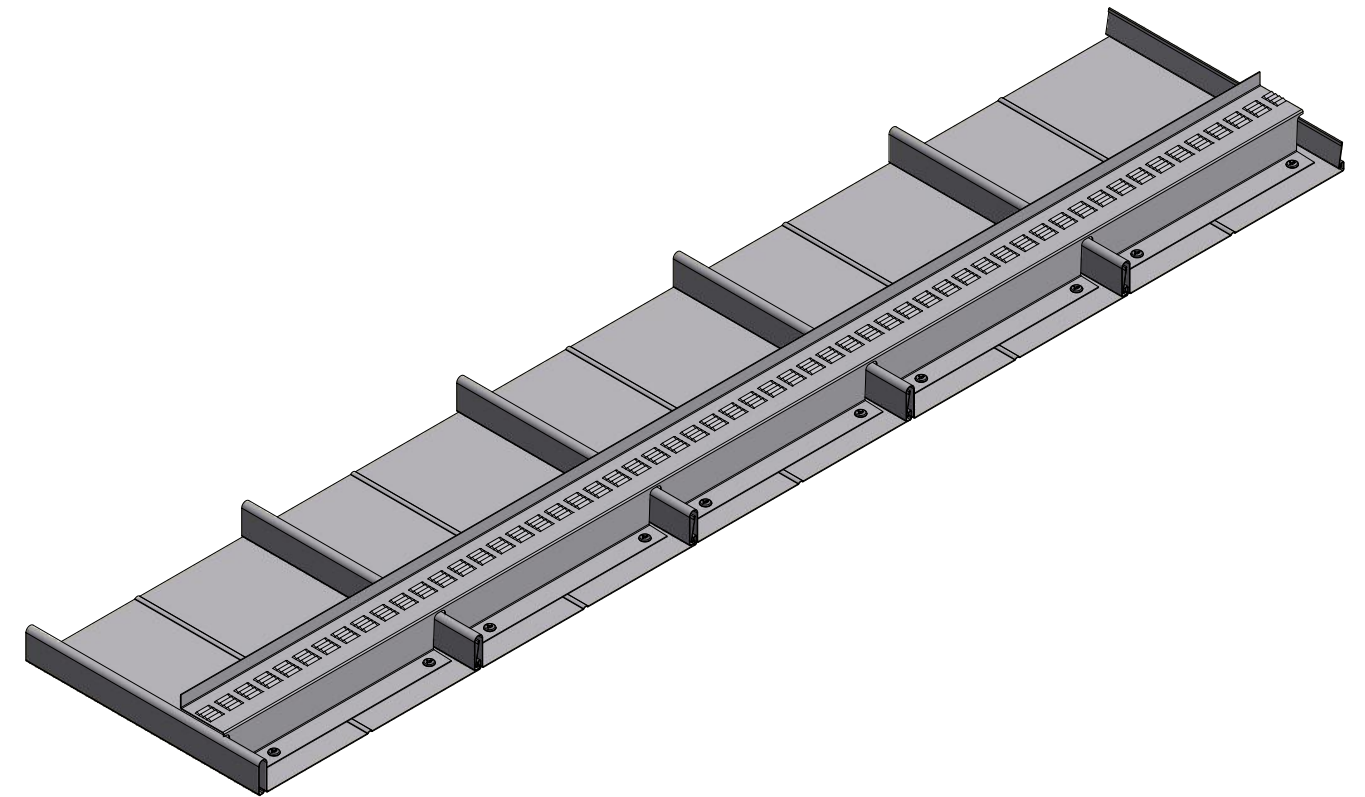

Pre-Notched "Z" Closures also available for vented applications

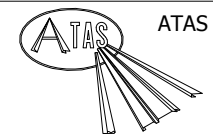

ATAS INTERNATIONAL, INC
 Allentown PA
 610-395-8445
 Mesa AZ
 480-558-7210

TITLE			Pre-Notched "Z" Closures		
DWG. NO.		DR		DATE	
		PJR		04-08-13	
MATERIAL		APP		DATE	
		SH. SIZE		SCALE	
		B		X:X	

REV. NO.	DATE	DESCRIPTION OF REVISION	BY	APP